

Parts Directory

Content

| | |
|---|----|
| Selector 6 - find the right protection plate to your welding filter | 69 |
| 3M™ Speedglas™ Welding Helmet 9100 | 70 |
| 3M™ Speedglas™ Welding Helmet 9100 FX | 72 |
| 3M™ Speedglas™ Welding Helmet 9100-QR | 74 |
| 3M™ Speedglas™ Welding Helmet 9002NC | 76 |
| 3M™ Speedglas™ Welding Helmet SL | 77 |
| 3M™ Speedglas™ Welding Helmet 100/100-QR | 78 |
| 3M™ Welding Helmet 10V/10-QR | 80 |
| Spare parts for older 3M™ Speedglas™ Welding Helmets (non-air) | 81 |
| Selector 7 - powered and supplied air system overview | 82 |
| Upgrade to the latest welding helmet systems | 83 |
| 3M™ Adflo™ Powered Air Respirator | 84 |
| 3M™ Versaflo™ Supplied Air Regulators | 86 |
| 3M™ Aircare™ Filtration Systems | 86 |
| 3M™ Speedglas™ Welding Helmet 9100-Air | 88 |
| 3M™ Speedglas™ Welding Helmet 9100 FX-Air | 90 |
| 3M™ Speedglas™ Welding Helmet 9100 MP/MP-Lite | 92 |
| Spare parts for older 3M™ Speedglas™ Welding Helmets (for respirator systems) | 94 |
| 3M™ Safety Helmet H-701 | 95 |
| 3M™ Versaflo™ M-Series Headtops | 96 |
| 3M™ Protective Visor DIN 5 | 97 |
| Product index | 98 |



As the outer protection plate becomes deeply pitted, scratched or too dirty to clean with soft cloth, it's probably time to replace it. Ensure you order the right plate to your filter:

| Outer protection plate | | For welding filter model | | | | | | | |
|------------------------|-------------------------|--------------------------|-------|-------------------|-----------------|----|------------|-----|--------|
| Part No | Description | 9100V | 9100X | 9100XX 9100XXi | 9100 Passive | SL | 100 Series | 10V | 9002NC |
| 12 60 00 | Standard | | | | | | | ● | |
| 42 60 00 | Standard | | | | | | | | ● |
| 42 70 00 | Scratch resistant | | | | | | | | ● |
| 42 70 71 | Heat resistant | | | | | | | | ● |
| 52 60 00 | Standard | ● | ● | ● | ● | | | | |
| 52 70 00 | Scratch resistant | ● | ● | ● | ● | | | | |
| 52 70 01 | Extra Scratch resistant | ● | ● | ● | ● | | | | |
| 52 70 70 | Heat resistant | ● | ● | ● | ● | | | | |
| 72 60 00 | Standard | | | | | ● | | | |
| 72 70 00 | Scratch resistant | | | | | ● | | | |
| 77 60 00 | Standard | | | | | | ● | | |
| 77 70 00 | Scratch resistant | | | | | | ● | | |
| 77 70 70 | Heat resistant | | | | | | ● | | |

The table shows our current program of welding filters, if you have an older helmet model check page 81 for consumables.

Regularly clean the inner cover plate with a soft cloth and replace if any pits or scratches occur. Ensure you order the right plate to your filter:

| Inner cover plate | | | For welding filter model | | | | | | | |
|-------------------|-------------|---------------|--------------------------|-------|-------------------|-----------------------------|----|--------------|-----|--------|
| Part No | Description | L x H (mm) | 9100V | 9100X | 9100XX 9100XXi | 9100 Passive 100 Passive | SL | 100S 100V | 10V | 9002NC |
| 12 60 00 | Clear | 110×90 | | | | ● | | | | |
| 42 80 00 | Clear | 91×42 | | | | | ● | ● | ● | |
| 42 80 10 | Clear | 103×53 | | | | | | | | ● |
| 42 80 30 | +1 Shade | 103×53 | | | | | | | | ● |
| 42 80 50 | +2 Shade | 103×53 | | | | | | | | ● |
| 52 80 05 | Clear | 117×50 | ● | | | | | | | |
| 52 80 06 | +1 Shade | 117×50 | ● | | | | | | | |
| 52 80 07 | +2 Shade | 117×50 | ● | | | | | | | |
| 52 80 15 | Clear | 117×61 | | ● | | | | | | |
| 52 80 16 | +1 Shade | 117×61 | | ● | | | | | | |
| 52 80 17 | +2 Shade | 117×61 | | ● | | | | | | |
| 52 80 25 | Clear | 117×77 | | | ● | | | | | |
| 52 80 26 | +1 Shade | 117×77 | | | ● | | | | | |
| 52 80 27 | +2 Shade | 117×77 | | | ● | | | | | |

The table shows our current program of welding filters, if you have an older helmet model check page 81 for consumables.

3M™ Speedglas™ Welding Helmet 9100



50 18 26



50 18 00



50 00 26



50 00 01



50 00 05



50 00 15



50 00 25

Helmets with side windows – auto-darkening filter

| Part No | Description |
|----------|---|
| 50 18 15 | With Speedglas welding filter 9100X (54×107 mm). |
| 50 18 25 | With Speedglas welding filter 9100XX (73×107 mm). |
| 50 18 26 | With Speedglas filter kit 9100XXi, incl welding filter and front cover 9100XXi (73×107 mm). |

Helmets without welding filter

| Part No | Description |
|----------|---|
| 50 11 00 | Welding helmet 9100 without side windows, with headband and silver front. |
| 50 18 00 | Welding helmet 9100 with side windows, headband and front cover. |

Welding filters

| Part No | Description |
|----------|--|
| 50 00 01 | Passive filter kit 9100 shade 11 (90×110 mm). |
| 50 00 05 | Auto-darkening filter 9100V, variable shade 5, 8, 9–13 (45×93 mm). |
| 50 00 15 | Auto-darkening filter 9100X, variable shade 5, 8, 9–13 (54×107 mm). |
| 50 00 25 | Auto-darkening filter 9100XX, variable shade 5, 8, 9–13 (73×107 mm). |
| 50 00 26 | Auto-darkening filter 9100XXi variable shade 5, 8, 9–13 (73×107 mm). |



3M™ Speedglas™ Welding Filter Kit 9100XXi

Our top-of-the-line welding filter with improved optics and a special designed front cover with external controls for grinding and memory modes. This complete kit (front cover and welding filter) is compatible with Speedglas welding helmet models 9100, 9100-Air and 9100-QR.

Read more about the new 9100XXi welding filter on page 16.



Part No:
50 01 26 Welding filter and front cover 9100XXi

Spare parts & accessories for 3M™ Speedglas™ Welding Helmet 9100

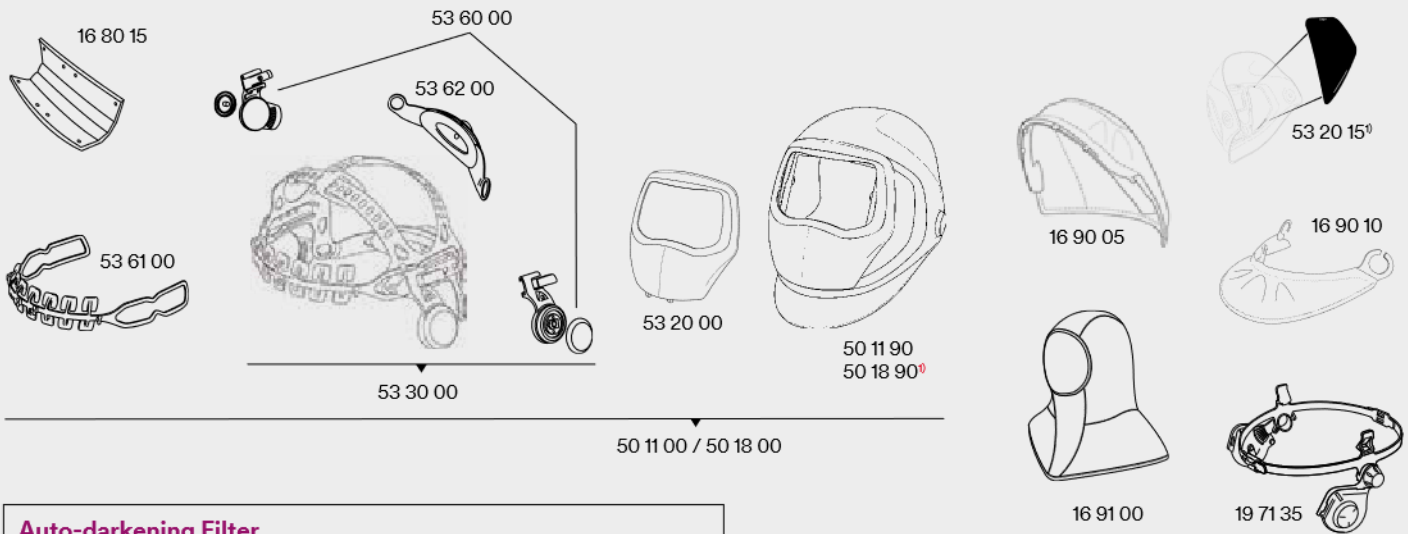

Auto-darkening Filter

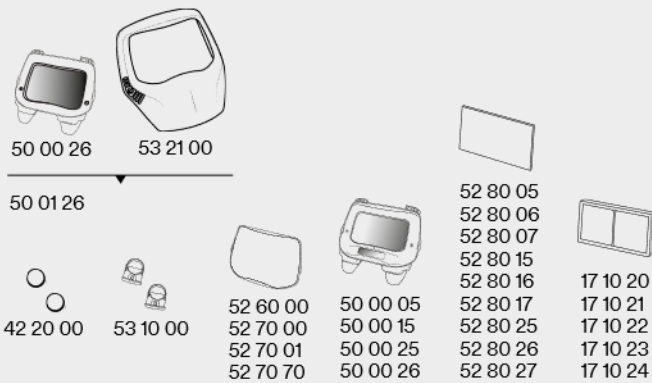

Passive Filter

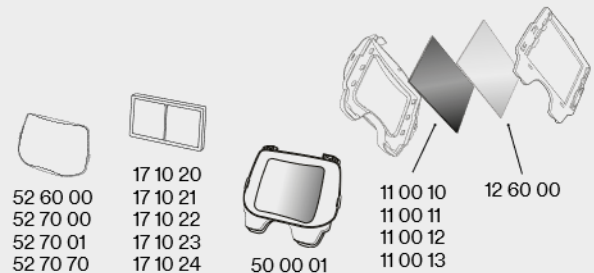

| Part No | Description | Part No | Description | Part No | Description |
|----------|---|------------------------|---|------------------------|--|
| 11 00 10 | Passive welding filter lens shade 10 (90×110). | 50 00 26 | Speedglas welding filter 9100XXi. | 52 80 07 | Inner cover plate, +2 shade for 9100V filters, pkg of 3. |
| 11 00 11 | Passive welding filter lens shade 11 (90×110). | 50 01 26 | Speedglas welding filter kit 9100XXi (incl front cover and welding filter). | 52 80 15 | Inner cover plate for 9100X filter, pkg of 5. Plate marking 117×61. |
| 11 00 12 | Passive welding filter lens shade 12 (90×110). | 50 11 00 | Welding helmet without side windows, with headband. | 52 80 16 | Inner cover plate, +1 shade for 9100X filter, pkg of 3. |
| 11 00 13 | Passive welding filter lens shade 13 (90×110). | 50 11 90 | Welding helmet without side windows, without headband, with front cover 9100. | 52 80 17 | Inner cover plate, +2 shade for 9100X filter, pkg of 3. |
| 12 60 00 | Inner cover plate for passive filter 9100. | 50 18 00 | Welding helmet with side windows and headband, with front cover 9100. | 52 80 25 | Inner cover plate for 9100XX filter, pkg of 5. Plate marking 117×77. |
| 16 80 15 | Comfort sweatband, pkg of 3. | 50 18 90 ¹⁾ | Welding helmet with side windows, without headband, with front cover. | 52 80 26 | Inner cover plate, +1 shade for 9100XX filter, pkg of 3. |
| 16 90 05 | Head protection. | 52 60 00 | Outer protection plate standard, pkg of 10. | 52 80 27 | Inner cover plate, +2 shade for 9100XX filter, pkg of 3. |
| 16 90 10 | Neck protection. | 52 70 00 | Outer protection plate scratch resistant, pkg of 10. | 53 10 00 | Battery holder, pkg of 2. |
| 16 91 00 | Hood. | 52 70 01 | Outer protection plate extra scratch resistant, pkg of 10. | 53 20 00 | Heat-reflecting front cover 9100. |
| 17 10 20 | Magnifying lens 1.0. | 52 70 70 | Outer protection plate heat resistant, pkg of 10. | 53 20 15 ¹⁾ | Side windows cover plate, 2 pairs. |
| 17 10 21 | Magnifying lens 1.5. | 52 80 05 | Inner cover plate for 9100V filter, pkg of 5. Plate marking 117×50. | 53 21 00 | Heat-reflecting front cover 9100XXi. |
| 17 10 22 | Magnifying lens 2.0. | 52 80 06 | Inner cover plate, +1 shade for 9100V filters, pkg of 3. | 53 30 00 | Headband with assembly parts. |
| 17 10 23 | Magnifying lens 2.5. | | | 53 60 00 | Pivot mechanism, left and right. |
| 17 10 24 | Magnifying lens 3.0. | | | 53 61 00 | Headband front part. |
| 19 71 35 | Safety helmet adapter 9100, with assembly parts. | | | 53 62 00 | Headband back part. |
| 42 20 00 | Battery, pkg of 2. | | | | |
| 50 00 01 | Speedglas passive welding filter kit 9100 (shade 11). | | | | |
| 50 00 05 | Speedglas welding filter 9100V. | | | | |
| 50 00 15 | Speedglas welding filter 9100X. | | | | |
| 50 00 25 | Speedglas welding filter 9100XX. | | | | |

1) Please use Part No 50 18 90 when new side windows are required.

3M™ Speedglas™ Welding Helmet 9100 FX



50 00 26



50 00 01



50 00 05



50 00 15



50 00 25

Helmets with side windows – and auto-darkening filter

| Part No | Description |
|----------|---|
| 54 18 15 | With Speedglas welding filter 9100X (54×107 mm). |
| 54 18 25 | With Speedglas welding filter 9100XX (73×107 mm). |
| 54 18 26 | With Speedglas welding with filter 9100XXi (73×107 mm). |

Helmet without welding filter

| Part No | Description |
|----------|---|
| 54 18 00 | Welding helmet 9100 FX with side windows, headband and front cover. |

Alternative 3M™ Speedglas™ Welding Filters

| Part No | Description |
|----------|--|
| 50 00 01 | Passive filter kit 9100 shade 11 (90×110 mm). |
| 50 00 05 | Auto-darkening filter 9100V, variable shade 5, 8, 9–13 (45×93 mm). |
| 50 00 15 | Auto-darkening filter 9100X, variable shade 5, 8, 9–13 (54×107 mm). |
| 50 00 25 | Auto-darkening filter 9100XX, variable shade 5, 8, 9–13 (73×107 mm). |
| 50 00 26 | Auto-darkening filter 9100XXi variable shade 5, 8, 9–13 (73×107 mm). |

Passive filters combined in flip-up helmets

With the 3M™ Speedglas™ Flip-up Welding Helmets, the side windows offer additional peripheral welding vision. Now also compatible with passive welding filters appropriate for long, continuous welds and less sensitive to humidity and heat.

Excellent low-cost options for large, 110 × 90 mm welding viewing area. And you can easily upgrade to a high performance Speedglas auto-darkening filter at any time.



Spare parts & accessories for 3M™ Speedglas™ Welding Helmet 9100 FX

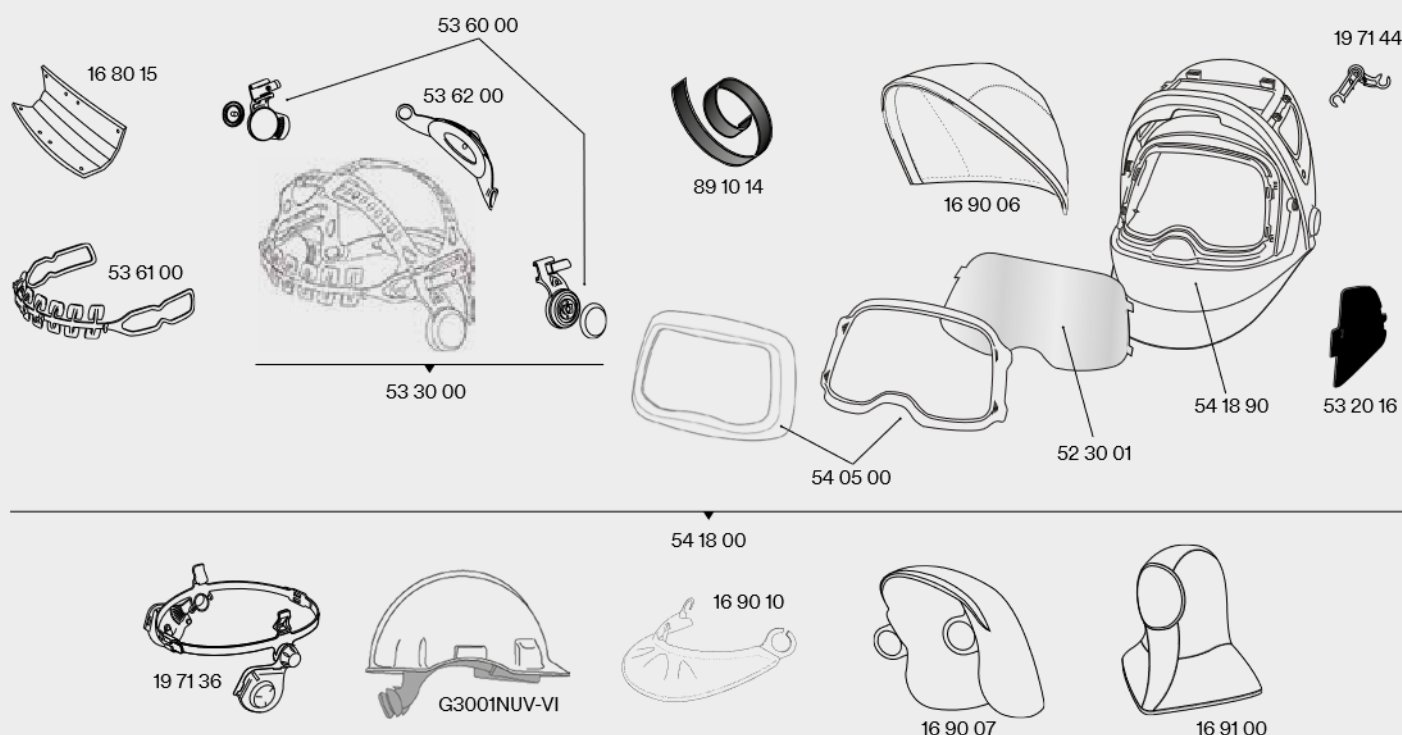

Auto-darkening Filter

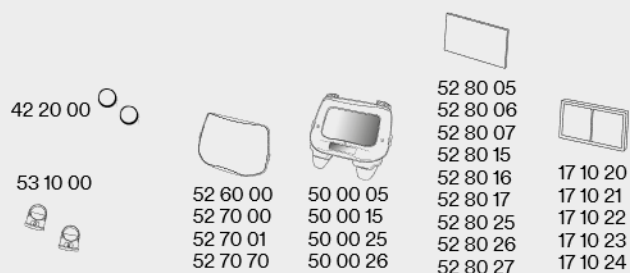

Passive Filter

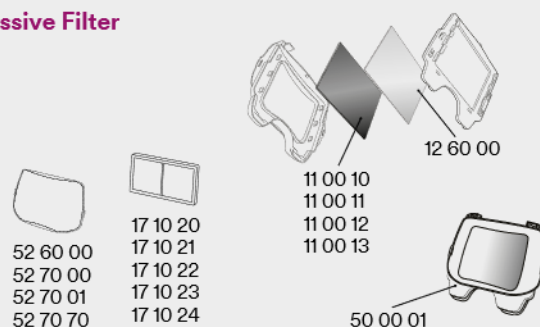

| Part No | Description | Part No | Description | Part No | Description |
|----------|---|----------|---|-------------|--|
| 11 00 10 | Passive welding filter lens shade 10. | 50 00 15 | Speedglas welding filter 9100X. | 52 80 25 | Inner cover plate for 9100XX filter, pkg of 5. Plate marking 117x77. |
| 11 00 11 | Passive welding filter lens shade 11. | 50 00 25 | Speedglas welding filter 9100XX. | 52 80 26 | Inner cover plate, +1 shade for 9100XX filter, pkg of 3. |
| 11 00 12 | Passive welding filter lens shade 12. | 50 00 26 | Speedglas welding filter 9100XXi. | 52 80 27 | Inner cover plate, +2 shade for 9100XX filter, pkg of 3. |
| 11 00 13 | Passive welding filter lens shade 13. | 52 30 01 | Visor plate anti-fog, pkg of 5. | 53 10 00 | Battery holder, pkg of 2. |
| 12 60 00 | Inner cover plate for passive filter 9100. | 52 60 00 | Outer protection plate, standard, pkg of 10. | 53 20 16 | Side windows cover plate, 2 pairs. |
| 16 80 15 | Comfort sweatband, pkg of 3. | 52 70 00 | Outer protection plate scratch resistant, pkg of 10. | 53 30 00 | Headband with assembly parts. |
| 16 90 06 | Head protection (small). | 52 70 01 | Outer protection plate extra scratch resistant, pkg of 10. | 53 60 00 | Pivot mechanism, left and right. |
| 16 90 07 | Head protection (large). | 52 70 70 | Outer protection plate, heat resistant pkg of 10. | 53 61 00 | Headband front part. |
| 16 90 10 | Neck protection, black. | 52 80 05 | Inner cover plate for 9100V filter, pkg of 5. Plate marking 117x50. | 53 62 00 | Headband back part. |
| 16 91 00 | Hood, black/grey. | 52 80 06 | Inner cover plate, +1 shade for 9100V filters, pkg of 3. | 54 05 00 | Front cover kit. |
| 17 10 20 | Magnifying lens 1.0. | 52 80 07 | Inner cover plate, +2 shade for 9100V filters, pkg of 3. | 54 18 00 | Welding helmet, without welding filter, with headband. |
| 17 10 21 | Magnifying lens 1.5. | 52 80 15 | Inner cover plate for 9100X filter, pkg of 5. Plate marking 117x61. | 54 18 90 | Welding helmet, without welding filter, without headband. |
| 17 10 22 | Magnifying lens 2.0. | 52 80 16 | Inner cover plate, +1 shade for 9100X filter, pkg of 3. | 89 10 14 | Hook & loop for headcover, pkg of 2. |
| 17 10 23 | Magnifying lens 2.5. | 52 80 17 | Inner cover plate, +2 shade for 9100X filter, pkg of 3. | 53 62 00 | Headband back part. |
| 17 10 24 | Magnifying lens 3.0. | | | G3001NUV-VI | 3M™ Safety Helmet G3001, white (unvented). |
| 19 71 36 | Safety helmet adapter 9100FX, with assembly parts. | | | | |
| 19 71 44 | Hinge mechanism, 2 pcs | | | | |
| 42 20 00 | Battery CR2032 Lithium 3V, pkg of 2. | | | | |
| 50 00 01 | Speedglas passive welding filter kit 9100 (shade 11). | | | | |
| 50 00 05 | Speedglas welding filter 9100V. | | | | |

3M™ Speedglas™ Welding Helmet 9100-QR



50 00 26

50 00 01



50 00 05

50 00 15

50 00 25

Welding helmets – with 3M™ Safety Helmet H-701

| Part No | Description |
|----------|---|
| 58 36 15 | With Speedglas welding filter 9100X, with rail and safety helmet (54×107 mm). |
| 58 36 25 | With Speedglas welding filter 9100XX (73×107 mm). |
| 58 36 26 | With Speedglas welding filter kit 9100XXi, incl welding filter (73×107 mm) and front cover 9100XXi. |

Welding helmets – without safety helmet

| Part No | Description |
|----------|--|
| 58 26 00 | With QR rail, without welding filter. |
| 58 26 15 | With QR rail and Speedglas welding filter 9100X. |
| 58 26 25 | With QR rail and Speedglas welding filter 9100XX (54×107 mm). |
| 58 26 26 | With QR rail and Speedglas welding filter kit 9100XXi and rail, incl welding filter (73×107 mm) and front cover. |

Alternative 3M™ Speedglas™ Welding Filters

| Part No | Description |
|----------|--|
| 50 00 01 | Passive filter kit 9100, shade 11 (90×110 mm). |
| 50 00 05 | Auto-darkening filter 9100V, variable shade 5, 8, 9–13 (45×93 mm). |
| 50 00 15 | Auto-darkening filter 9100X, variable shade 5, 8, 9–13 (54×107 mm). |
| 50 00 25 | Auto-darkening filter 9100XX, variable shade 5, 8, 9–13 (73×107 mm). |
| 50 00 26 | Auto-darkening filter 9100XXi variable shade 5, 8, 9–13 (73×107 mm). |



Distance bar

To avoid scratches on the larger welding filters (9100X, 9100XX, 9100XXi) when raising the welding helmet, we recommend using this distance bar (included when you buy a complete helmet with these welding filters). Also sold as spare part.

Part No 53 11 00



Earmuff bar

When using ear muffs, we recommend you to install this earmuff bar to widen the 9100-QR welding helmet.

Sold as separate accessory.

Part No 53 31 00

Spare parts & accessories for 3M™ Speedglas™ Welding Filters & Helmet 9100-QR parts

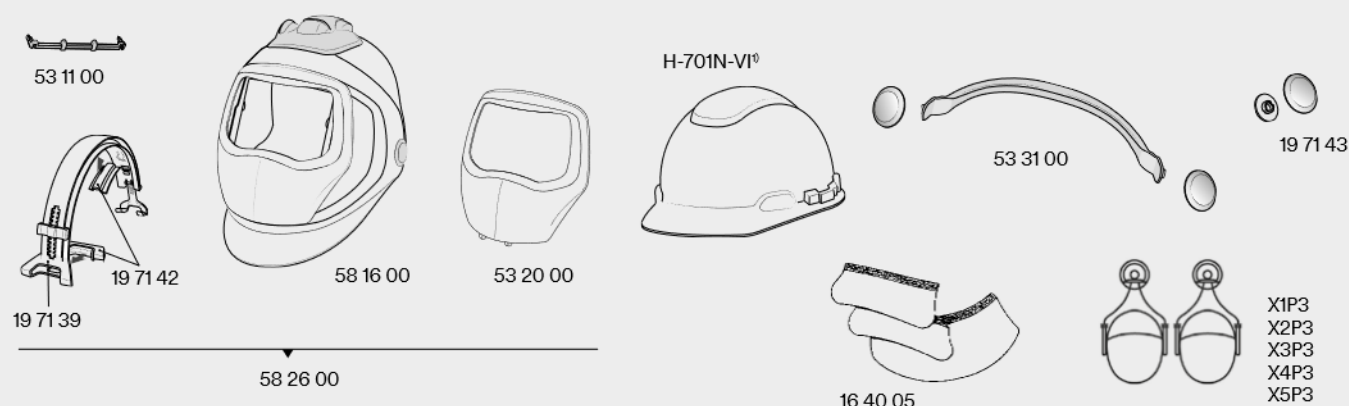

Auto-darkening Filter

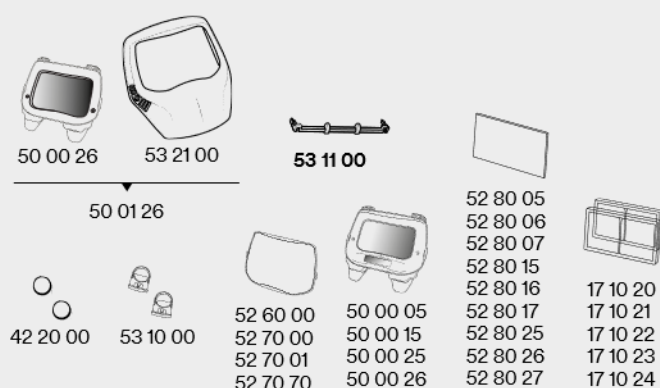

Passive Filter

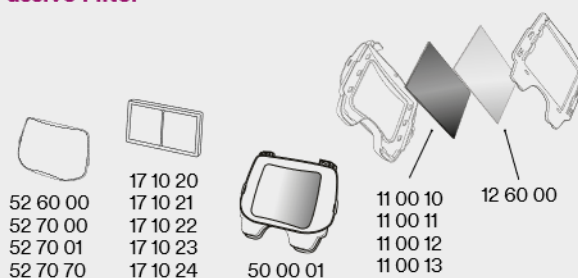

| Part No | Description | Part No | Description | Part No | Description |
|----------|---|----------|--|-------------------------|---|
| 11 00 10 | Passive welding filter lens shade 10. | 52 70 00 | Outer protection plate scratch resistant, pkg of 10. | 53 10 00 | Battery holder for welding filter series 9100, pkg of 2. |
| 11 00 11 | Passive welding filter lens shade 11. | 52 70 01 | Outer protection plate extra scratch resistant, pkg of 10. | 53 11 00 | Distance bar for welding filters 9100X, 9100XX and 9100XXi. |
| 11 00 12 | Passive welding filter lens shade 12. | 52 70 70 | Outer protection plate heat resistant, pkg of 10. | 53 21 00 | Heat-reflecting front cover for welding filter kit 9100XXi. |
| 11 00 13 | Passive welding filter lens shade 13. | 52 80 05 | Inner cover plate for 9100V filter, pkg of 5. Plate marking 117×50. | 53 31 00 | Ear muff bar for Speedglas welding helmet 9100-QR. |
| 12 60 00 | Inner cover plate for passive filter 9100. | 52 80 06 | Inner cover plate, +1 shade for 9100V filters, pkg of 3. | 58 16 00 | Welding helmet 9100-QR without rail, without welding filter, without safety helmet. |
| 16 40 05 | Ear and neck protection in leather. | 52 80 07 | Inner cover plate, +2 shade for 9100V filters, pkg of 3. | 58 26 00 | Welding helmet 9100-QR with rail, without welding filter, without safety helmet. |
| 19 71 39 | Quick release rail for safety helmet. | 52 80 15 | Inner cover plate for 9100X filter, pkg of 5. Plate marking 117×61. | H-701N-VI ¹⁾ | 3M™ Safety Helmet H-701R, white (unvented). |
| 19 71 42 | Rubber friction pads for quick release rail. | 52 80 16 | Inner cover plate, +1 shade for 9100X filter, pkg of 3. | X1P3 | 3M™ Peltor™ Earmuffs X1 (26 dB) helmet attachment. |
| 19 71 43 | Pivot cover plate kit for quick release welding helmets, pkg of 2. | 52 80 17 | Inner cover plate, +2 shade for 9100X filter, pkg of 3. | X2P3 | 3M™ Peltor™ Earmuffs X2 (30 dB) helmet attachment. |
| 42 20 00 | Battery CR2032 Lithium 3V, pkg of 2. | 52 80 25 | Inner cover plate for 9100XX filter, pkg of 5. Plate marking 117×77. | X3P3 | 3M™ Peltor™ Earmuffs X3 (32 dB) helmet attachment. |
| 50 00 01 | Speedglas passive welding filter kit 9100 (shade 11). | 52 80 26 | Inner cover plate, +1 shade for 9100XX filter, pkg of 3. | X4P3 | 3M™ Peltor™ Earmuffs X4 (33 dB) helmet attachment. |
| 50 00 05 | Speedglas welding filter 9100V. | 52 80 27 | Inner cover plate, +2 shade for 9100XX filter, pkg of 3. | X5P3 | 3M™ Peltor™ Earmuffs X5 (36 dB) helmet attachment. |
| 50 00 15 | Speedglas welding filter 9100X. | | | | |
| 50 00 25 | Speedglas welding filter 9100XX. | | | | |
| 50 00 26 | Speedglas welding filter 9100XXi. | | | | |
| 50 01 26 | Speedglas welding filter kit 9100XXi (incl front cover and welding filter). | | | | |
| 52 60 00 | Outer protection plate standard, pkg of 10. | | | | |

1) Many alternative colours available, see page 95

3M™ Speedglas™ Welding Helmet 9002NC



Helmet with auto-darkening filter

| Part No | Description |
|----------|---|
| 40 13 85 | Welding helmet without side windows, with welding filter 9002NC, variable shade 8–12 (54×107 mm). |

Welding filter (only)

| Part No | Description |
|----------|--|
| 40 00 85 | 3M™ Speedglas™ Welding Filter 9002NC, variable shade 8–12 (54×107 mm). |

Spare parts & accessories for 3M™ Speedglas™ Welding Helmet 9002NC

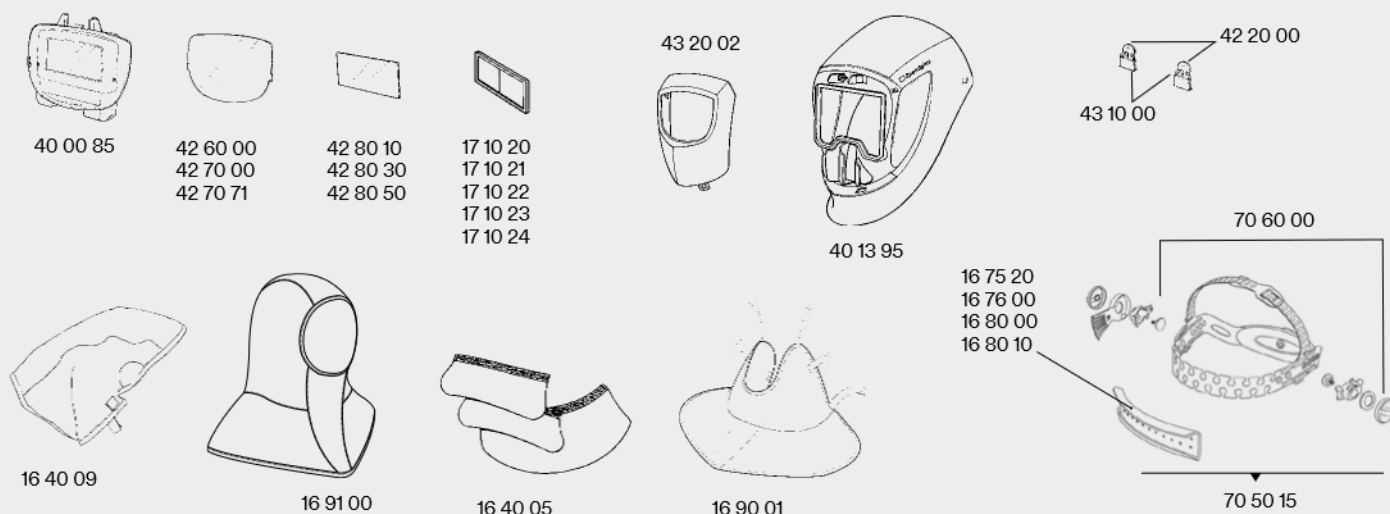

| Part No | Description | Part No | Description | Part No | Description |
|----------|---|----------|---|----------|---|
| 16 40 05 | Ear and neck protection in leather. | 40 00 85 | Speedglas welding filter 9002NC, shade 8–12. | 42 80 50 | Inner cover plate, +2 Shades, pkg of 5. |
| 16 40 09 | Head protection. | 42 20 00 | Battery CR2032 Lithium 3V, pkg of 2. | 43 10 00 | Battery cover, pkg of 2. |
| 16 75 20 | Sweatband towelling, pkg of 2. | 42 60 00 | Outer protection plate, standard, pkg of 10. Plate marking 42 01 50. | 43 20 02 | Front cover |
| 16 80 00 | Sweatband, leather. | 42 70 00 | Outer protection plate, scratch resistant, pkg of 10. Plate marking 42 01 00. | 70 50 15 | Headband with assembly parts. |
| 16 80 10 | Sweatband, fleecy cotton, pkg of 2. | 42 70 71 | Outer protection plate, heat resistant, pkg of 10. Plate marking 42 01 71 HEAT. | 70 60 00 | Assembly parts for headband. |
| 16 90 01 | Neck protection. | 42 80 10 | Inner cover plate pkg of 5. Plate marking 42 02 10. | | |
| 16 91 00 | Hood. | 42 80 30 | Inner cover plate, +1 Shade, pkg of 5. | | |
| 17 10 20 | Magnifying lens 1.0. | | | | |
| 17 10 21 | Magnifying lens 1.5. | | | | |
| 17 10 22 | Magnifying lens 2.0. | | | | |
| 17 10 23 | Magnifying lens 2.5. | | | | |
| 17 10 24 | Magnifying lens 3.0. | | | | |
| 40 13 95 | Welding helmet 9000, without Side windows, without front, without headband, without filter. | | | | |

3M™ Speedglas™ Welding Helmet SL



Helmet with auto-darkening filter

| Part No | Description |
|-----------------|--|
| 70 11 20 | Welding helmet SL with welding filter, variable shade 8–12 (42×93 mm). |

Welding filter (only)

| Part No | Description |
|-----------------|--|
| 70 00 20 | 3M™ Speedglas™ Welding Filter SL, variable shade 8–12 h(42×93 mm). |

Spare parts & accessories for 3M™ Speedglas™ Welding Helmet SL

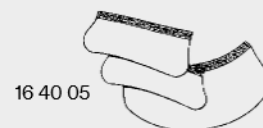
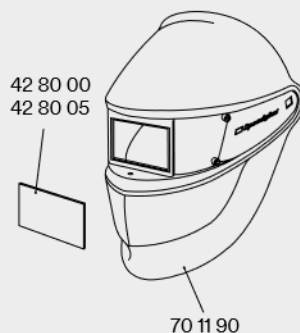
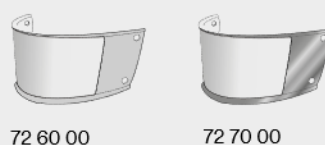
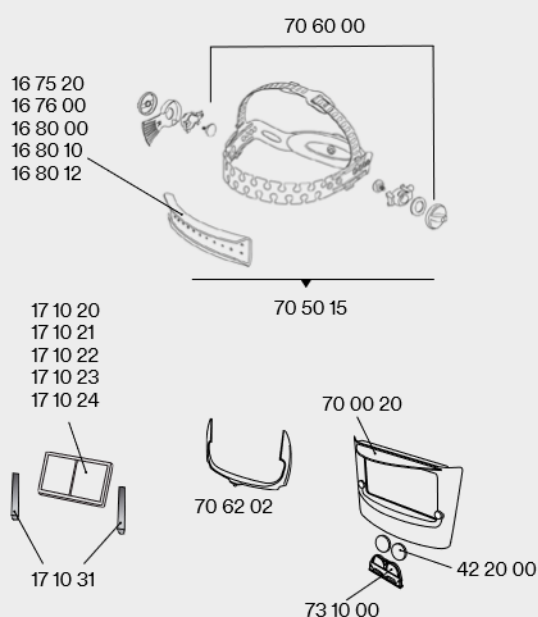

| Part No | Description | Part No | Description | Part No | Description |
|-----------------|---|-----------------|---|-----------------|--|
| 16 40 05 | Ear and neck protection in leather (3 parts). | 17 10 20 | Magnifying lens 1.0. | 70 11 90 | Welding helmet, without headband. |
| 16 75 20 | Sweatband, towelling, purple, pkg of 2. | 17 10 21 | Magnifying lens 1.5. | 70 50 15 | Headband with assembly parts. |
| 16 76 00 | Sweatband, towelling, pkg of 20. | 17 10 22 | Magnifying lens 2.0. | 70 60 00 | Assembly parts for headband. |
| 16 80 00 | Sweatband, leather. | 17 10 23 | Magnifying lens 2.5. | 70 62 02 | Filter locking frame, pkg of 2. |
| 16 80 10 | Sweatband, fleecy cotton, pkg of 2. | 17 10 24 | Magnifying lens 3.0. | 72 60 00 | Outer protection plate, standard, pkg of 5. Plate marking 030226. |
| 16 80 12 | Sweatband, fleecy cotton, pkg of 2. | 17 10 31 | Holder for magnifying lens. | 72 70 00 | Outer protection plate, scratch resistant, pkg of 5. Plate marking 030248. |
| 16 90 01 | Neck protection. | 42 20 00 | Battery CR2032 Lithium 3V, pkg of 2. | 73 10 00 | Battery cover. |
| 16 91 00 | Hood black/grey. | 42 80 00 | Inner cover plate pkg of 5. Plate marking 42 02 00. | | |
| | | 42 80 05 | 42 80 00, pkg of 200. | | |
| | | 70 00 20 | Speedglas welding filter SL. | | |

3M™ Speedglas™ Welding Helmet Series 100/100-QR



75 11 10



78 35 20



75 00 10



75 00 11



75 00 20

3M™ Speedglas™ Welding Helmet 100 (black)

| Part No | Description |
|----------|---|
| 75 11 01 | With passive welding filter, shade 11. |
| 75 11 20 | With Speedglas welding filter 100V, variable shade 8–12 (44×93 mm). |
| 75 11 90 | Without welding filter, without headband. |

3M™ Speedglas™ Welding Helmet 100-QR

| Part No | Description |
|----------|---|
| 78 25 20 | Welding helmet 100-QR without welding filter, without safety helmet, with QR rail. |
| 78 35 20 | Welding helmet 100-QR with 3M safety helmet H-701R QR rail and welding filter 100-V (44×93 mm). |

Alternative 3M™ Speedglas™ Welding Filters

| Part No | Description |
|----------|--|
| 75 00 10 | Auto-darkening filter 100S-10, single shade 10 (44×93 mm). |
| 75 00 11 | Auto-darkening filter 100S-11, single shade 11 (44×93 mm). |
| 75 00 20 | Auto-darkening filter 100-V, variable shade 8–12 (44×93 mm). |



Skull helmet

| Part No | Description |
|----------|-------------------|
| 75 28 20 | With filter 100V. |



Motor helmet

| Part No | Description |
|----------|-------------------|
| 75 29 20 | With filter 100V. |



Ice Hot helmet

| Part No | Description |
|----------|-------------------|
| 75 25 20 | With filter 100V. |



Xterminator helmet

| Part No | Description |
|----------|-------------------|
| 75 22 20 | With filter 100V. |



Razor Dragon helmet

| Part No | Description |
|----------|-------------------|
| 75 24 20 | With filter 100V. |



Raging Skull helmet

| Part No | Description |
|----------|-------------------|
| 75 26 20 | With filter 100V. |



Trojan Warrior helmet

| Part No | Description |
|----------|-------------------|
| 75 16 20 | With filter 100V. |



Blaze helmet

| Part No | Description |
|----------|-------------------|
| 75 12 20 | With filter 100V. |



Aces High helmet

| Part No | Description |
|----------|-------------------|
| 75 17 20 | With filter 100V. |



Steel Rose helmet

| Part No | Description |
|----------|-------------------|
| 75 18 20 | With filter 100V. |



Wild 'n' Pink helmet

| Part No | Description |
|----------|-------------------|
| 75 20 20 | With filter 100V. |

Spare parts & accessories for 3M™ Speedglas™ Welding Helmet Series 100/100-QR

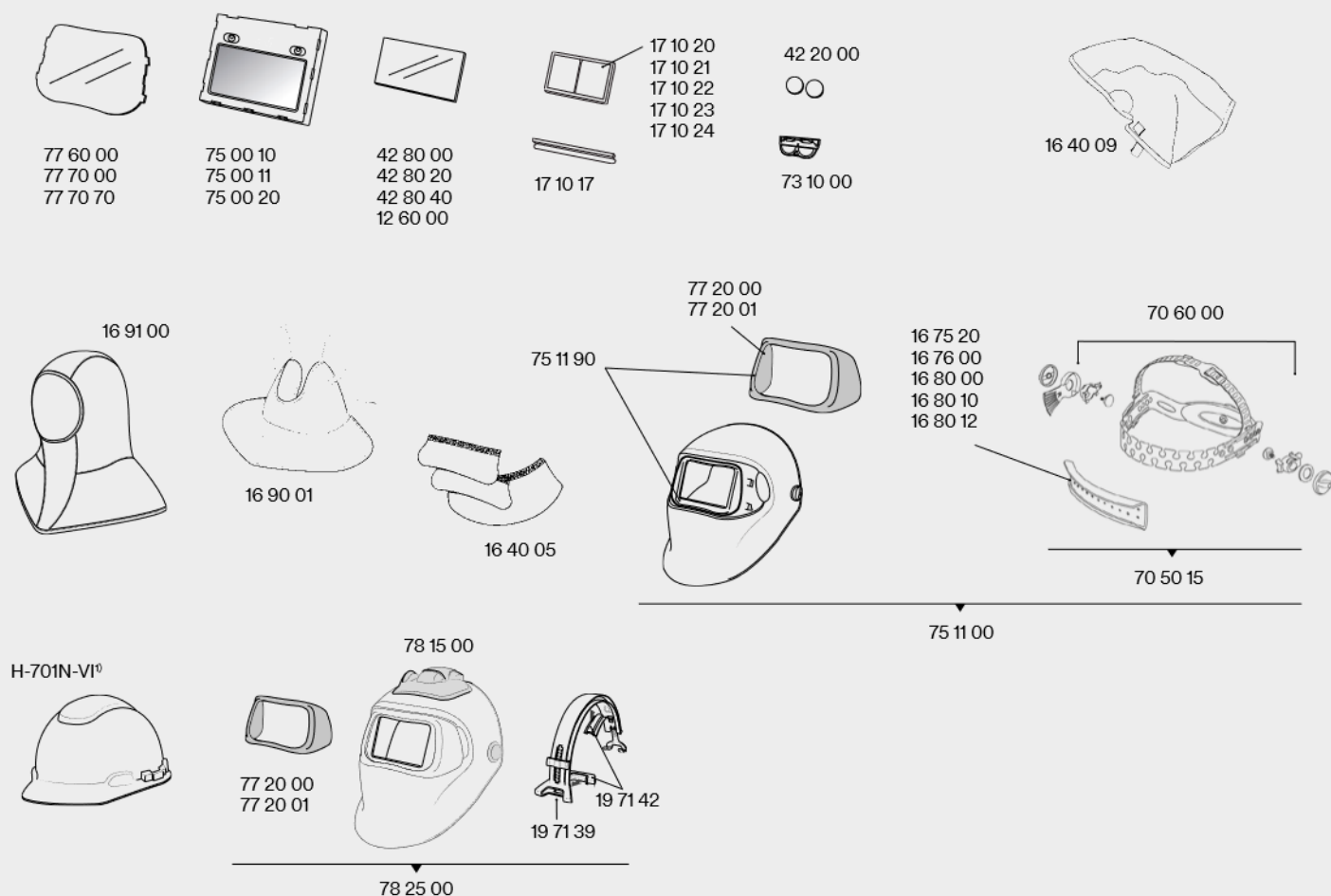

| Part No | Description | Part No | Description | Part No | Description |
|-----------------|---|-----------------|---|-------------------------------|---|
| 12 60 00 | Inner cover plate for 100 passive filter. | 19 71 43 | Pivot cover plate kit for quick release welding helmets (QR), pkg of 2. | 75 11 90 | 100 welding helmet black, without filter, without headband. |
| 16 40 05 | Ear and neck protection in leather. | 42 20 00 | Battery CR2032 Lithium 3V, pkg of 2. | 77 20 00 | Front frame, silver. |
| 16 40 09 | Head protection. | 42 80 00 | Inner cover plate, pkg of 5. | 77 20 01 | Front frame, black. |
| 16 75 20 | Sweatband, towelling purple, pkg of 2. | 42 80 20 | Inner cover plate, +1 shade, pkg of 5. | 77 60 00 | Outer protection plate, standard, pkg of 10. |
| 16 76 00 | Sweatband, towelling purple, pkg of 20. | 42 80 40 | Inner cover plate, +2 shade, pkg of 5. | 77 70 00 | Outer protection plate, scratch resistant, pkg of 10. |
| 16 80 00 | Sweatband, leather. | 70 50 15 | Headband with assembly parts. | 77 70 70 | Outer protection plate, heat resistant, pkg of 10. |
| 16 80 10 | Sweatband, fleecy cotton, pkg of 2. | 70 60 00 | Assembly parts for headband. | 78 15 00 | Welding helmet 100-QR without rail, without filter, without safety helmet. |
| 16 80 12 | Sweatband, fleecy cotton (short), pkg of 2. | 73 10 00 | Battery cover. | 78 25 00 | Welding helmet 100-QR with rail, without welding filter, without safety helmet. |
| 16 90 01 | Neck protection. | 75 00 10 | Speedglas welding filter 100S-10, single shade 10. | 78 35 20 | Welding helmet 100-QR with rail and 3M™ Safety Helmet H-701R with filter 100-V. |
| 16 91 00 | Hood. | 75 00 11 | Speedglas welding filter 100S-11, single shade 11. | H-701N-VI¹⁾ | White 3M™ Safety Helmet H-701R (unvented), with ratchet suspension. |
| 17 10 17 | Holder for magnifier (older models of welding filters). | 75 00 20 | Speedglas welding filter 100V, variable shade 8–12. | | |
| 17 10 20 | Magnifying lens 1.0. | 75 05 11 | Speedglas 100 passive kit: 110×90 mm passive welding filter shade 11, inner cover plate, outer protection plate and filter frame (not shown). | | |
| 17 10 21 | Magnifying lens 1.5. | 75 11 00 | 100 welding helmet black, without filter, with headband. | | |
| 17 10 22 | Magnifying lens 2.0. | | | | |
| 17 10 23 | Magnifying lens 2.5. | | | | |
| 17 10 24 | Magnifying lens 3.0. | | | | |
| 19 71 37 | Safety helmet adapter (loop), with assembly parts, not shown. | | | | |
| 19 71 39 | Quick release rail for safety helmet. | | | | |
| 19 71 42 | Rubber friction pads for quick release rail. | | | | |

1) Many alternative colours available, see page 95

3M™ Welding Helmets 10V/10-QR



3M™ Welding Helmet 10V

| Part No | Description |
|----------|---|
| 10 11 01 | with welding filter 10V, variable shade 10-12 (44×93 mm). |



3M™ Welding Helmet 10-QR

| Part No | Description |
|----------|--|
| 10 11 03 | With welding filter 10V, QR rail and 3M™ Safety Helmet H-701 |



3M™ Welding Filter 10V

| Part No | Description |
|----------|--|
| 10 00 03 | Welding filter 10V, variable shade 10-12 (44×93 mm). |

Spare parts & accessories for 3M™ Welding Helmets 10V/10-QR

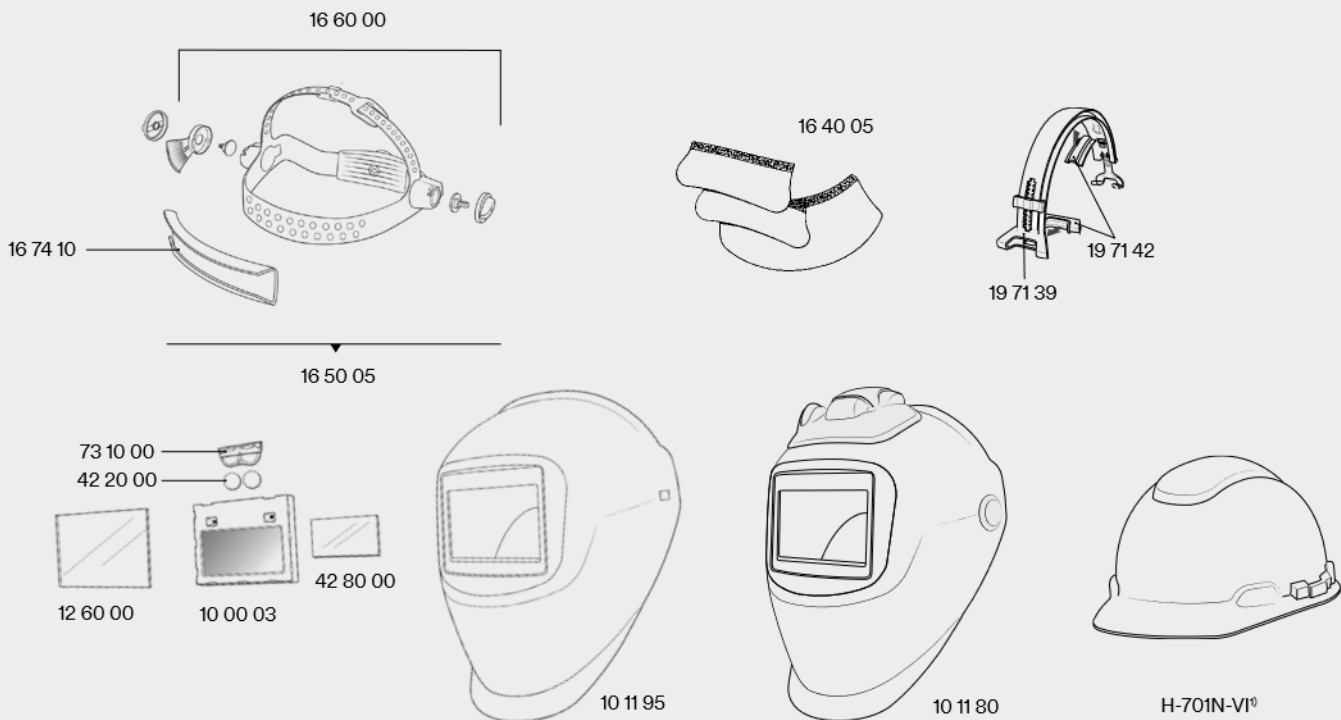

| Part No | Description | Part No | Description | Part No | Description |
|----------|--|----------|--|-------------------------|---|
| 10 00 03 | 3M welding filter 10V, shade 10-12. | 16 50 05 | Headband with assembly parts. | 42 80 00 | Inner cover plate pkg of 5. Plate marking 42 02 00. |
| 10 11 80 | Welding helmet 10-QR, without filter, without safety helmet. | 16 60 00 | Assembly parts for headband. | 73 10 00 | Battery cover. |
| 10 11 95 | Welding helmet 10V without headband, without welding filter. | 16 74 10 | Sweatband. | H-701N-VI ¹⁾ | White 3M™ Safety Helmet H-701R (unvented), with ratchet suspension. |
| 12 60 00 | Outer protection plate. | 19 71 39 | Quick release rail for safety helmet. | | |
| 16 40 05 | Ear and neck protection in leather (3 parts). | 19 71 42 | Rubber friction pads for quick release rail. | | |
| | | 42 20 00 | Battery CR2032 Lithium 3V, pkg of 2. | | |

1) Many alternative colours available, see page 95

3M™ Speedglas™ Welding Helmets FlexView / ProTop / Utility



Spare parts for 3M™ Speedglas™ Welding Helmets FlexView / ProTop / Utility

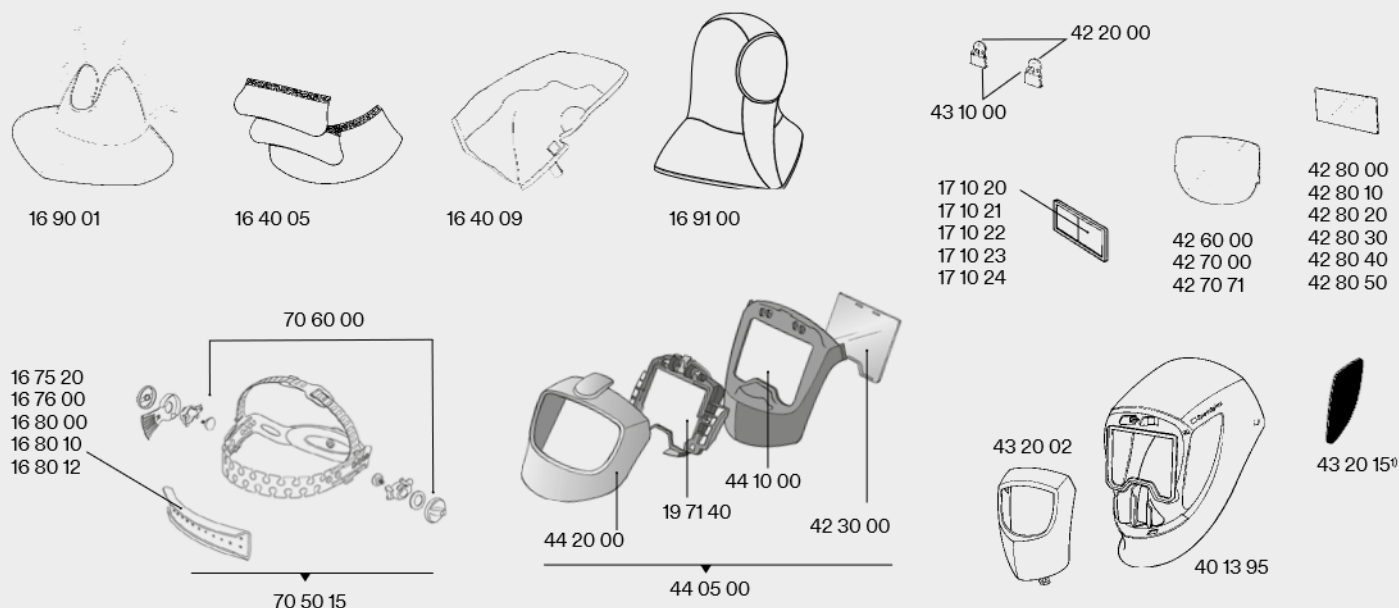

| Part No | Description | Part No | Description | Part No | Description |
|----------|--|----------|---|------------------------|--|
| 16 40 05 | Ear and neck protection in leather. | 42 30 00 | Protective visor plate FlexView, pkg of 10. | 42 80 50 | Inner cover plate (53×103 mm), +2 Shade pkg of 5. |
| 16 40 09 | Head protection. | 42 60 00 | Outer protection plate, standard, pkg of 10. Plate marking 42 01 50. | 43 10 00 | Battery cover, pkg of 2. |
| 16 75 20 | Sweatband towelling, pkg of 2. | 42 70 00 | Outer protection plate, scratch resistant, pkg of 10. Plate marking 42 01 00. | 43 20 02 | Front cover. |
| 16 76 00 | Sweatband towelling, pkg of 20. | 42 70 71 | Outer protection plate, heat resistant, pkg of 10. Plate marking 42 01 71 HEAT. | 40 13 95 | Helmet without side windows, without headband, without welding filter. |
| 16 80 00 | Sweatband, leather. | 42 80 00 | Inner cover plate (42×91 mm) pkg of 5. Plate marking 42 02 00. | 43 20 15 ¹⁾ | Side windows cover plate (sticker), 5 pairs. |
| 16 80 10 | Sweatband, fleecy cotton (long), pkg of 2. | 42 80 10 | Inner cover plate (53×103 mm) pkg of 5. Plate marking 42 02 10. | 44 05 00 | Speedglas FlexView Conversion Kit. |
| 16 90 01 | Neck protection. | 42 80 20 | Inner cover plate (42×91 mm), +1 Shade for 9002D/9002V filters, pkg of 5. | 44 10 00 | Middle helmet FlexView, black. |
| 16 91 00 | Hood. | 42 80 30 | Inner cover plate (53×103 mm), +1 Shade pkg of 5. | 44 20 00 | Front cover FlexView, silver. |
| 17 10 15 | Holder for magnifying lens (not shown). | 42 80 40 | Inner cover plate (42×91 mm), +2 Shade pkg of 5. | 70 50 15 | Headband with assembly parts. |
| 17 10 20 | Magnifying lens 1.0. | | | 70 60 00 | Assembly parts for headband. |
| 17 10 21 | Magnifying lens 1.5. | | | | |
| 17 10 22 | Magnifying lens 2.0. | | | | |
| 17 10 23 | Magnifying lens 2.5. | | | | |
| 17 10 24 | Magnifying lens 3.0. | | | | |
| 19 71 40 | Holder for welding filter (FlexView). | | | | |
| 19 71 41 | Locking wedge kit, holder welding filter (FlexView). | | | | |
| 42 20 00 | Battery CR2032 Lithium 3V, pkg of 2. | | | | |

1) Please use Part No 40 18 90 when new side windows are required.

Welding and grinding respiratory systems

3M™ Speedglas™ Welding Helmets



3M™ Versaflo™ Headtops



3M™ Adflo™ Powered Air Respirator



3M™ Adflo™ High-Altitude Powered Air Respirator²⁾



3M™ Versaflo™ Supplied Air Regulators



Breathing tubes³⁾



The QRS (Quick Release Swivel) breathing tubes allow fast and easy connection. Most systems comes with the self-adjusting length for improved fit, made in polyurethane (834016). As an alternative the high durability rubber tube (834017) is sold separately.

Breathing tubes



The QRS (Quick Release Swivel) breathing tubes allow fast and easy connection. Most systems comes with the self-adjusting length for improved fit, made in polyurethane (834016). As an alternative the high durability rubber tube (834017) is sold separately.

Filters and accessories



1. Prefilter¹⁾
2. Particle filter¹⁾
3. Odour filter
Not needed when you use gas filter.
4. Heavy-duty battery
Extends the operation hours to 10–13 hours (7–9 hours with standard battery).
5. Gas filter A1B1E1³⁾
6. Gas filter A2³⁾
7. Braces
8. Backpack

More information about Adflo accessories [see page 84](#).

Air Supply



1. 3M™ Aircare™ Filtration Units (wall-mounted or stand alone)
2. Couplings and branch sets
3. Air supply tubes (7,5–30 m)

More information about air supply [see page 86](#).

¹⁾ Included as standard when you order a complete respiratory system with welding helmet and air delivery unit; must always be used.

²⁾ For welders working at higher altitudes there is a special respirator version to adjust for changes in air density: 3M™ Adflo™ High Altitude Turbo.

³⁾ Gas filter must always be used together with a particle filter and we recommend to use a heavy-duty battery (sold separately: 83 76 31). In some configurations it is also required to use a breathing tube with silencer (non-QRS: 83 40 08) in combination with a QRS breathing tube adapter (53 35 05), always verify approved combinations with your Safety Engineer or contact a certified Industrial Hygienist for advice.



Still using an older version of our welding respiratory helmets?

Did you know you can easily upgrade to our current premium welding helmets, without buying a new Adflo or Versaflo system?

Our 9100 series helmets feature the QRS (Quick Release Swivel) type of breathing tube, which enables one-handed connection and release.

Below you will find ordering information to get a helmet kit, including welding filter and breathing tube. To help protect your new helmet system from scratches, we include a special Speedglas storage bag for free.



**3M™ Speedglas™
Welding Helmet 9100-Air**
Part No Description

| | |
|-----------------|---|
| 56 90 15 | Welding helmet 9100-Air with welding filter 9100X (54×107 mm), self-adjusting QRS breathing tube (52.5 to 85 cm) and storage bag. |
| 56 90 25 | Welding helmet 9100-Air welding filter 9100XX (73×107 mm), self-adjusting QRS breathing tube (52.5 to 85 cm) and storage bag. |
| 56 90 26 | Welding helmet 9100-Air welding filter 9100XXi (73×107 mm), self-adjusting QRS breathing tube (52.5 to 85 cm) and storage bag. |



**3M™ Speedglas™
Welding Helmet 9100 FX-Air**
Part No Description

| | |
|-----------------|---|
| 54 90 15 | Welding helmet 9100 FX-Air welding filter 9100X (54×107 mm), self-adjusting QRS breathing tube (52.5 to 85 cm) and storage bag. |
| 54 90 25 | Welding helmet 9100 FX-Air welding filter 9100XX (73×107 mm), self-adjusting QRS breathing tube (52.5 to 85 cm) and storage bag. |
| 54 90 26 | Welding helmet 9100 FX-Air welding filter 9100XXi (73×107 mm), self-adjusting QRS breathing tube (52.5 to 85 cm) and storage bag. |



**3M™ Speedglas™
Welding Helmet 9100MP**
Part No Description

| | |
|-----------------|--|
| 57 90 15 | Welding helmet 9100MP welding filter 9100X (54×107 mm), self-adjusting QRS breathing tube (52.5 to 85 cm) and storage bag. |
| 57 90 25 | Welding helmet 9100MP welding filter 9100XX (73×107 mm), self-adjusting QRS breathing tube (52.5 to 85 cm) and storage bag. |
| 57 90 26 | Welding helmet 9100MP welding filter 9100XXi (73×107 mm), self-adjusting QRS breathing tube (52.5 to 85 cm) and storage bag. |

3M™ Adflo™ Powered Air Respirator



Respirator without headtop – standard battery

| Part No | Description |
|----------|--|
| 83 77 30 | Adflo respirator with self-adjusting breathing tube QRS, breathing tube adapter, airflow indicator, prefilter, spark arrestor, particle filter, battery, belt and charger. |

For gas filter configuration we recommend using the Adflo respirator with heavy-duty battery.



Respirator without headtop – heavy duty battery

| Part No | Description |
|----------|---|
| 83 77 31 | Adflo respirator with self-adjusting breathing tube QRS, breathing tube adapter, airflow indicator, prefilter, spark arrestor, particle filter, heavy-duty battery, belt and charger. |

For gas filter configuration please add these items to above order:
83 72 42 for gas filter A1B1E1, or
83 75 42 for gas filter A2.



High Altitude Respirator – standard or heavy duty battery

| Part No | Description |
|----------|--|
| 83 78 30 | Adflo High Altitude respirator with self-adjusting breathing tube QRS, breathing tube adapter, airflow indicator, prefilter, spark arrestor, particle filter, battery, belt and charger. |
| 83 78 31 | Adflo High Altitude respirator as in 83 78 30 but with heavy-duty battery. |

For gas filter configuration please add these items to above order:
83 72 42 for gas filter A1B1E1, or
83 75 42 for gas filter A2.



Standard battery

Don't get weighted down. A lightweight lithium-ion battery pack designed for the Adflo respirator.

- Run time 7–9 hours¹⁾
- Charging time 4 hours
- Compact and lightweight



Heavy-duty battery

Find your endurance. A high-capacity lithium-ion battery pack extends the operating hours of the respirator.

- Long run time 10–13 hours¹⁾
- Charging time 5.5 hours
- Compact and lightweight



3M™ Adflo™ Battery Charger Organizing Stand

The 6-position battery charger organizing stand for Adflo battery chargers provides the ability to charge six batteries at the same time, saving both time and hassle. Compatible with legacy NiMH batteries and the new Li-ion batteries. Flexible installation: either mount on wall or stand-alone.

Part No: 83 37 06

¹⁾ Expected operating times are when using a new, fully-charged battery, new particle filter and a standard airflow setting.

Spare parts & accessories 3M™ Adflo™ Powered Air Respirator

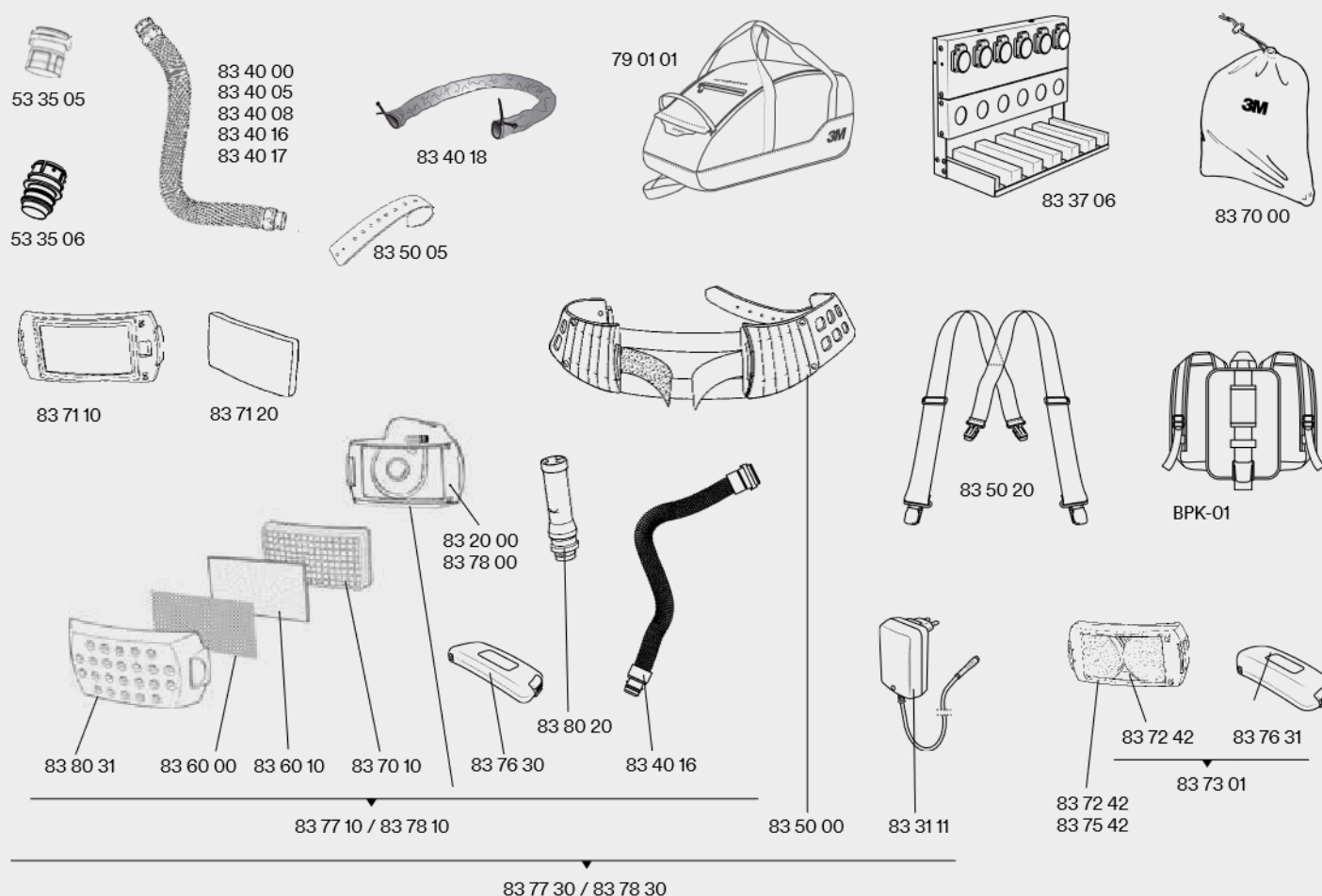

| Part No | Description | Part No | Description | Part No | Description |
|----------|--|----------|---|----------|---|
| 53 35 05 | Adapter for non-QRS breathing tubes when using Speedglas welding helmet series 9100. | 83 40 17 | Breathing tube, heavy-duty rubber (80 cm), with QRS connection. | 83 76 30 | Li-ion Battery (standard). |
| 53 35 06 | Adapter for QRS breathing tubes when using Speedglas welding helmet series 9000. | 83 40 18 | Flame resistant breathing tube cover. | 83 76 31 | Li-ion Battery Heavy-Duty. |
| 79 01 01 | Product carry bag. | 83 50 00 | Belt. | 83 77 10 | Adflo respirator with self-adjusting breathing tube QRS, adapter (53 35 06), airflow indicator, prefilter, spark arrestor, particle filter and battery. |
| 80 60 20 | Backpack. | 83 50 05 | Front part, belt. | 83 78 00 | Turbo assembly High Altitude, without filter, without filter cover. |
| 83 20 00 | Turbo assembly, without filter, without filter cover. | 83 50 10 | Quick connection for belt (not shown). | 83 78 10 | Adflo High Altitude respirator with self-adjusting breathing tube QRS, adapter (53 35 06), airflow indicator, prefilter, spark arrestor, particle filter and battery. |
| 83 31 11 | Battery charger for Li-ion batteries. | 83 50 20 | Braces. | 83 80 20 | Airflow indicator. |
| 83 37 06 | Battery charger organizing stand 6-position. | 83 60 00 | Spark arrestor. | 83 80 31 | Filter cover black. |
| 83 40 00 | Breathing tube, lightweight, non-QRS. | 83 60 10 | Prefilter, pkg of 5. | BPK-01 | Backpack. |
| 83 40 05 | Breathing tube, heavy-duty rubber, non-QRS. | 83 60 80 | Prefilter, pkg of 80. | | |
| 83 40 08 | Breathing tube with silencer, non-QRS. | 83 70 00 | Storage bag. | | |
| 83 40 16 | Breathing tube, self-adjusting (52,5 to 85 cm), with QRS connection. | 83 70 10 | Particle filter P SL. | | |
| | | 83 70 12 | Particle filter P SL, pkg of 2. | | |
| | | 83 70 20 | Particle filter P SL, pkg of 20. | | |
| | | 83 70 80 | Particle filter P SL, pkg of 80. | | |
| | | 83 71 10 | Odour filter. | | |
| | | 83 71 20 | Odour filter pad. | | |
| | | 83 72 42 | Gas filter A1B1E1. | | |
| | | 83 73 01 | Gas filter kit: A1B1E1 filter and Li-ion Heavy-Duty battery. | | |
| | | 83 75 42 | Gas filter A2. | | |

3M™ Versaflo™ Supplied Air Regulators



Versaflo supplied air regulator V-500

| Part No | Description |
|---------------|---|
| V-500E | Flow controlled supplied air regulator, including belt. |



Versaflo supplied air regulator V-100

| Part No | Description |
|---------------|---|
| V-100E | Air cooling supplied air regulator, including belt. |



Versaflo supplied air regulator V-200

| Part No | Description |
|---------------|---|
| V-200E | Air heating supplied air regulator, including belt. |

3M™ Aircare™ Filtration Systems

To make the quality of the air supply breathable, oil aerosols, water vapour, particulates, and non-toxic, unpleasant odours must be removed to EN 12021 requirements. The 3M™ Aircare™ Filtration Systems ACU-3 (wall mount) and ACU-4 (floor mount) provide three-stage filtration for up to three users or two users plus an air tool.

- A** Differential pressure indicator
- B** Pressure regulator (lockable)
- C** Pressure gauge
- D** Pre-filter
Semi Auto Drains (stage 1, 2) and Manual Drain (stage 3)
- E** Coalescing filter
- F** Absorber filter with activated charcoal

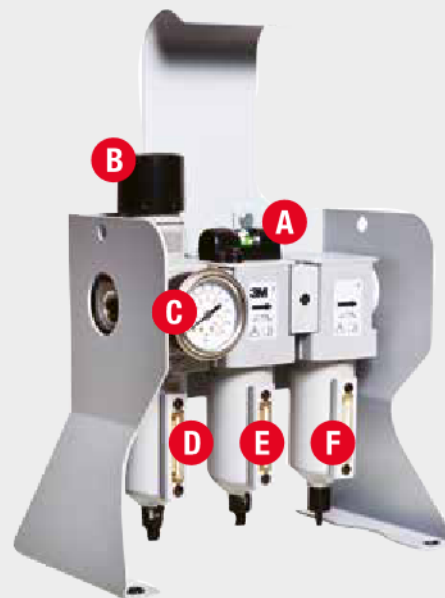

| Select type of regulator | Select Belt Unit Coupling Plug (1/4" BSP) | Select type of Air Supply Tube (Output 3/8" BSP - both ends) | Select Coupling Set for Air Supply Tube (3/8" BSP) | Select type of Branch Set (incl 3/8" BSP adapters) | Select Air Filtration Unit Input: 1/2" or 3/8" female thread BSP. (2 adapters included - 3/8" BSP to 3/8" male pipe thread BSP. Output: 3/8" BSP. |
|--|---|---|--|--|--|
| V-100E: Air cooling regulator V-100. | 530-12-52P3: Coupling plug Rectus 25. | 308-00-30P: 10 m standard duty hose. | 530-12-81P3: Coupling set Rectus 95. | 312-03-00P3: 3-Way Branch Set. | ACU-03: 3M™ Aircare™ Filtration System (wall mounted) |
| V-200: Air heating regulator V-200. | 530-12-53P3: Coupling plug CEJN. | 308-0031P: 30 m standard duty hose. | 530-12-82P3: Coupling set CEJN. | 312-03-01P3: 2-Way Branch Set. | ACU-04: 3M™ Aircare™ Filtration System (stand alone). |
| V-500E: Flow controlled regulator V-500. | | 308-00-40P: 7.5 m coiled hose. | | | |
| | | 308-00-72P: 10 m standard duty, antistatic, high temperature hose. | | | |

Spare parts & accessories for 3M™ Versaflo™ Supplied Air Regulators

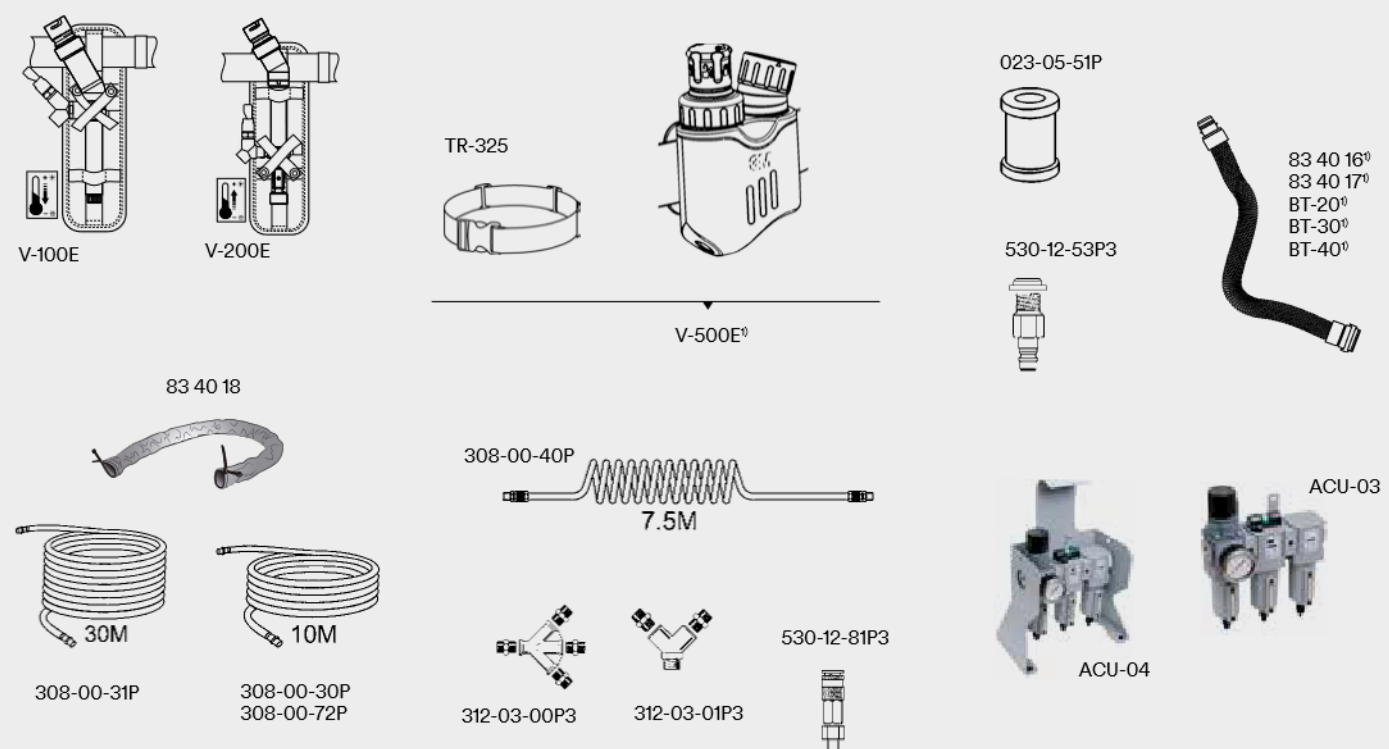

| Part No | Description | Part No | Description | Part No | Description |
|------------------------------|--|----------------------------|--|---------------------------|--|
| 83 40 16¹⁾ | Breathing tube, self-adjusting (52,5 to 85 cm), with QRS connection for Speedglas welding helmets. | 312-03-00P3 | 3-way manifold. | BT-30¹⁾ | Breathing tube, self-adjusting (52,5 to 85 cm), with QRS connection, for Versaflo headtops M-Series. |
| 83 40 17¹⁾ | Breathing tube, heavy-duty rubber (80 cm), with QRS connection for Speedglas welding helmets. | 312-03-01P3 | 2-way manifold. | BT-40¹⁾ | Breathing tube, heavy-duty rubber (80 cm), with QRS connection, for Versaflo headtops M-Series. |
| 83 40 18 | Flame resistant breathing tube cover. | 530-12-52P3 | Belt unit coupling plug - Rectus 25. | TR-325 | Belt. |
| 023-05-51P | Carbon filter. | 530-12-53P3 | Belt unit coupling plug - CEJN. | V-100E | Versaflo air cooling supplied air regulator V-100E, with belt. |
| 308-00-30P | Standard duty air supply tube, 10 m. | 530-12-81P3 | Socket and plug - Rectus 25. | V-200E | Versaflo air heating supplied air regulator V-200E, with belt. |
| 308-00-31P | Standard duty air supply tube, 30 m. | 530-12-82P3 | Socket and plug - CEJN. | V-500E | Versaflo flow controlled supplied air regulator V-500E with belt. |
| 308-00-40P | Coiled air supply tube, 7.5 m. | ACU-03 | 3M™ Aircare™ Filtration System (wall mounted). | | |
| 308-00-72P | Standard duty, anti-static, high temp air supply tube, 10 m. | ACU-04 | 3M™ Aircare™ Filtration System (stand alone). | | |
| | | BT-20L¹⁾ | Breathing tube with QRS connection, polyurethane (length 96,5 cm), for Versaflo headtops M-Series. | | |
| | | BT-20S¹⁾ | Breathing tube with QRS connection, polyurethane (length 73,5 cm), for Versaflo headtops M-Series. | | |

1) When the V-500E regulator is used with Versaflo headtops M-Series, the BT-Series breathing tubes must be used.

3M™ Speedglas™ Welding Helmet 9100-Air Systems



56 77 15



50 00 26



50 00 01



50 00 05



50 00 15



50 00 25

Helmet systems with powered air

| Part No | Description |
|------------------------|--|
| 56 77 00 ¹⁾ | Without welding filter, with Adflo powered air respirator. |
| 56 77 15 ¹⁾ | With Speedglas welding filter 9100X (54×107 mm) and Adflo powered air respirator. |
| 56 77 25 ¹⁾ | With Speedglas welding filter 9100XX (73×107 mm) and Adflo powered air respirator. |
| 56 77 26 ¹⁾ | With Speedglas welding filter kit 9100XXi, incl welding filter (73×107 mm) and front cover, with Adflo powered air respirator. |

Helmet systems with supplied air

| Part No | Description |
|------------------------|--|
| 56 85 00 ¹⁾ | Without welding filter, with Versaflo supplied air regulator V-500E. |

Please note, supplied air regulators with heating or cooling (V-100/V-200) only as separate order (not as system), see page 17 and 20.

Alternative 3M™ Speedglas™ Welding Filters

| Part No | Description |
|----------|---|
| 50 00 01 | Passive filter kit 9100 (90×110 mm), shade 11. |
| 50 00 05 | Auto-darkening filter 9100V (45×93 mm), variable shade 5, 8, 9–13. |
| 50 00 15 | Auto-darkening filter 9100X (54×107 mm), variable shade 5, 8, 9–13. |
| 50 00 25 | Auto-darkening filter 9100XX (73×107 mm), variable shade 5, 8, 9–13. |
| 50 00 26 | Auto-darkening filter 9100XXi (73×107 mm), variable shade 5, 8, 9–13. |

Maintenance tips for 3M™ Speedglas™ Welding Helmet 9100-Air

Subscribe to our YouTube channel to learn more about product features and maintenance. A few examples:



Scan QR-code or use this URL:

www.youtube.com/3MSpeedglas



Adjust the air duct length to your personal preferences.



A face seal in good working order is essential at all times. Do you know how to replace it?

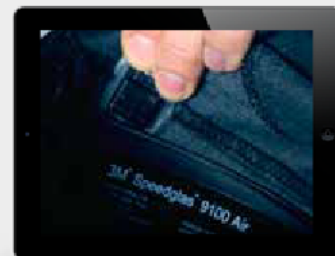

For additional protection against sparks or to cover for inside glare the extended head cover might be useful.

¹⁾ With storage bag (79 01 01)

Spare parts & accessories for 3M™ Speedglas™ Welding Helmet 9100-Air

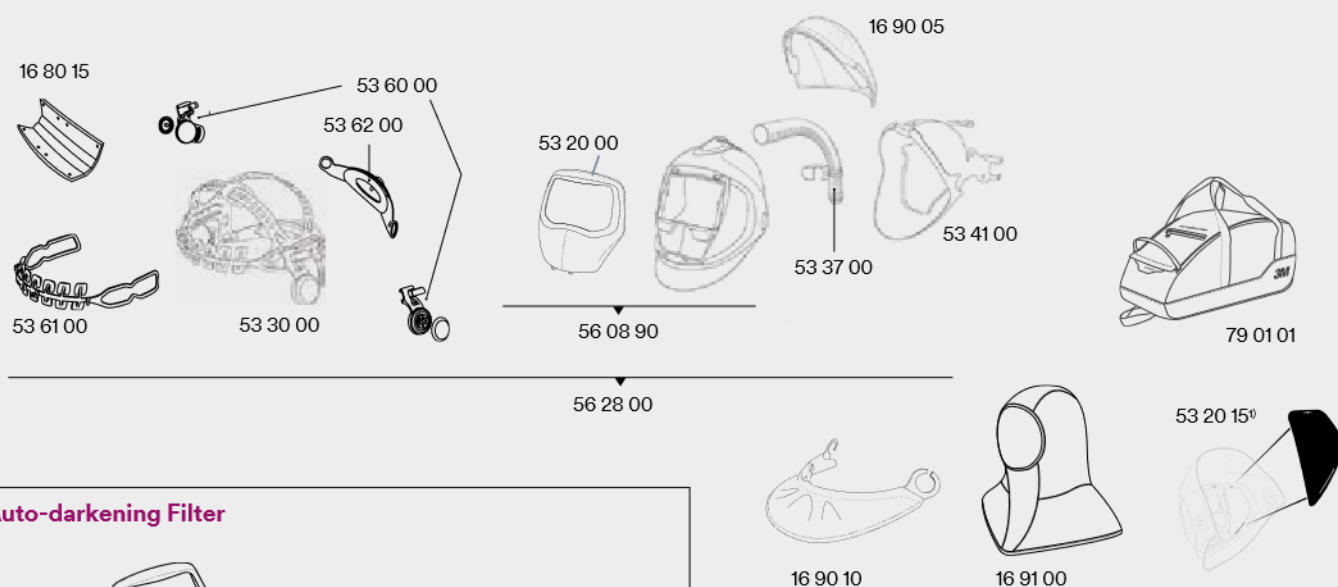

Auto-darkening Filter

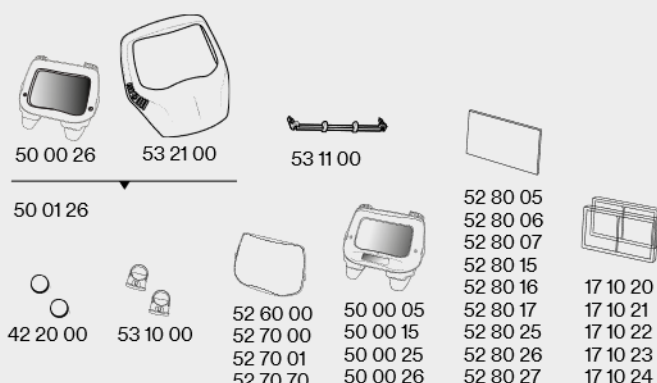

Passive Filter

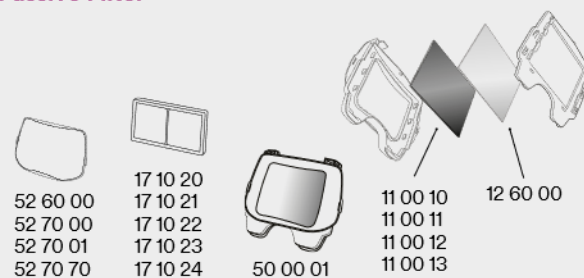

| Part No | Description | Part No | Description | Part No | Description |
|----------|---|----------|---|------------------------|--|
| 16 80 15 | Comfort sweatband, pkg of 3. | 52 70 01 | Outer protection plate, extra scratch resistant, pkg of 10. | 52 80 27 | Inner cover plate, +2 shade for 9100XX/9100XXi filters, pkg of 3. |
| 16 90 05 | Head protection. | 52 70 70 | Outer protection plate, heat resistant pkg of 10. | 53 10 00 | Battery holder, pkg of 2. |
| 16 90 10 | Neck protection. | 52 80 05 | Inner cover plate for 9100V filter, pkg of 5. Plate marking 117x50. | 53 20 00 | Heat-reflecting front cover 9100. |
| 16 91 00 | Hood. | 52 80 06 | Inner cover plate, +1 shade for 9100V filters, pkg of 3. | 53 20 15 ¹⁾ | Side windows cover plate, 2 pairs. |
| 17 10 20 | Magnifying lens 1.0. | 52 80 07 | Inner cover plate, +2 shade for 9100V filters, pkg of 3. | 53 21 00 | Heat-reflecting front cover 9100XXi. |
| 17 10 21 | Magnifying lens 1.5. | 52 80 15 | Inner cover plate for 9100X filter, pkg of 5. Plate marking 117x61. | 53 30 00 | Headband with assembly parts. |
| 17 10 22 | Magnifying lens 2.0. | 52 80 16 | Inner cover plate, +1 shade for 9100X filter, pkg of 3. | 53 37 00 | Air duct. |
| 17 10 23 | Magnifying lens 2.5. | 52 80 17 | Inner cover plate, +2 shade for 9100X filter, pkg of 3. | 53 41 00 | Face seal. |
| 17 10 24 | Magnifying lens 3.0. | 52 80 25 | Inner cover plate for 9100XX/9100XXi filters, pkg of 5. Plate marking 117x77. | 53 60 00 | Pivot mechanism, left and right. |
| 42 20 00 | Battery CR2032 Lithium 3V, pkg of 2. | 52 80 26 | Inner cover plate, +1 shade for 9100XX/9100XXi filters, pkg of 3. | 53 61 00 | Headband front part. |
| 50 00 05 | Speedglas welding filter 9100V. | 52 80 27 | Inner cover plate, +2 shade for 9100XX/9100XXi filters, pkg of 3. | 53 62 00 | Headband back part. |
| 50 00 15 | Speedglas welding filter 9100X. | | | 56 08 90 ¹⁾ | Speedglas welding helmet 9100 Air without headband, without air duct, without face seal, without welding filter. |
| 50 00 25 | Speedglas welding filter 9100XX. | | | 56 28 00 | Speedglas welding helmet 9100 Air, without welding filter. |
| 50 00 26 | Speedglas welding filter 9100XXi | | | 79 01 01 | Product storage bag. |
| 50 01 26 | Speedglas welding filter kit 9100XXi (incl front cover and welding filter). | | | | |
| 52 60 00 | Outer protection plate, standard, pkg of 10. | | | | |
| 52 70 00 | Outer protection plate scratch resistant, pkg of 10. | | | | |

1) Please use Part No 56 08 90 when new side windows are required.

3M™ Speedglas™ Welding Helmet 9100 FX-Air



54 77 25



50 00 26



50 00 01



50 00 05



50 00 15



50 00 25

Helmet systems with powered air

| Part No | Description |
|------------------------|--|
| 54 77 00 ¹⁾ | Without welding filter, with Adflo powered air respirator. |
| 54 77 15 ¹⁾ | With Speedglas welding filter 9100X (54×107 mm) and Adflo powered air respirator. |
| 54 77 25 ¹⁾ | With Speedglas welding filter 9100XX (73×107 mm) and Adflo powered air respirator. |
| 54 77 26 ¹⁾ | With Speedglas welding filter kit 9100XXi, incl welding filter (73×107 mm) and front cover, with Adflo powered air respirator. |

Helmet systems with supplied air

| Part No | Description |
|------------------------|--|
| 54 88 00 ¹⁾ | Without welding filter, with Versaflo supplied air regulator V-500E. |

Please note, supplied air regulators with heating or cooling (V-100/V-200) only as separate order (not as system), see page 17 and 20.

Alternative 3M™ Speedglas™ Welding Filters

| Part No | Description |
|----------|---|
| 50 00 01 | Passive filter kit 9100 (90×110 mm), shade 11. |
| 50 00 05 | Auto-darkening filter 9100V (45×93 mm), variable shade 5, 8, 9–13. |
| 50 00 15 | Auto-darkening filter 9100X (54×107 mm), variable shade 5, 8, 9–13. |
| 50 00 25 | Auto-darkening filter 9100XX (73×107 mm), variable shade 5, 8, 9–13. |
| 50 00 26 | Auto-darkening filter 9100XXi (73×107 mm), variable shade 5, 8, 9–13. |

Maintenance tips for 3M™ Speedglas™ Welding Helmet 9100 FX-Air

Subscribe to our YouTube channel to learn more about product features and maintenance. A few examples:



Scan QR-code or use this URL:

www.youtube.com/3MSpeedglas

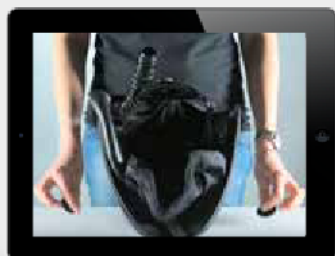

It is important that the face seal is correctly mounted and fitted to provide the correct protection factor.

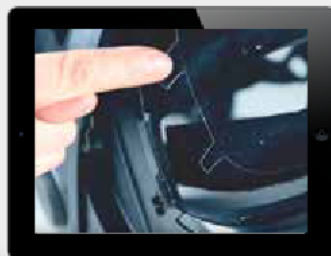

Is your clear visor not so clear anymore, after periods of frequent grinding? From our YouTube channel you will see how to replace it.



If you need additional protection for your head, see how to assemble the head cover for additional protection against sparks here.

¹⁾ With storage bag (79 01 01)

Spare parts & accessories for 3M™ Speedglas™ Welding Helmet 9100 FX-Air

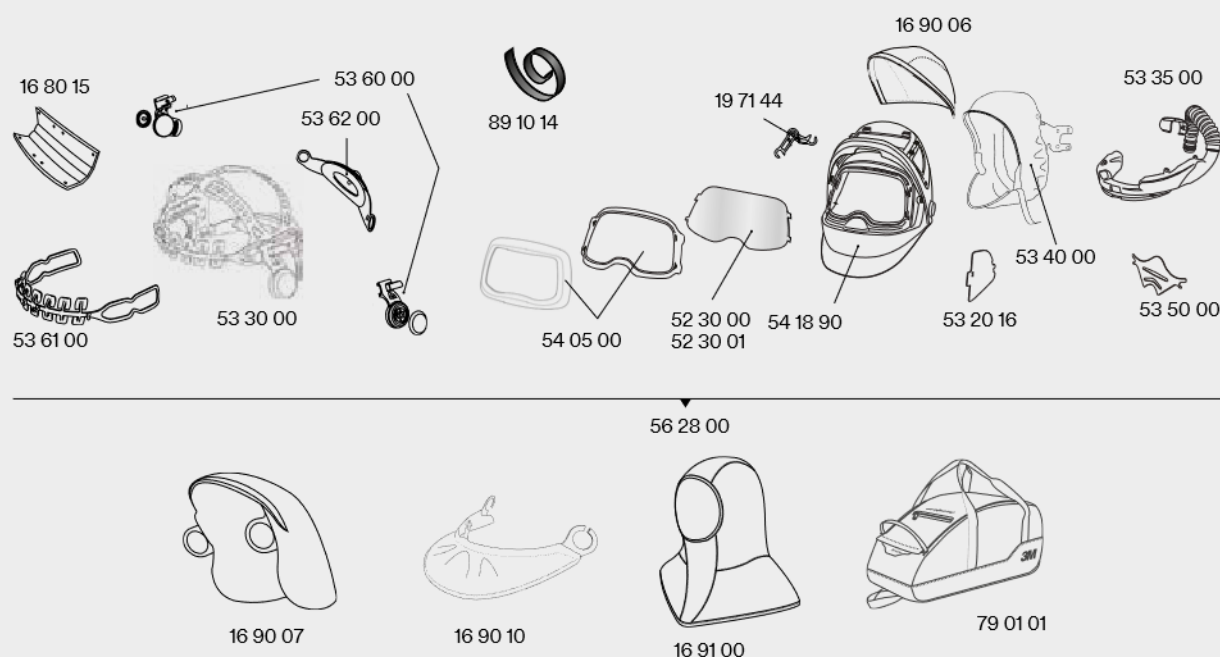

Auto-darkening Filter

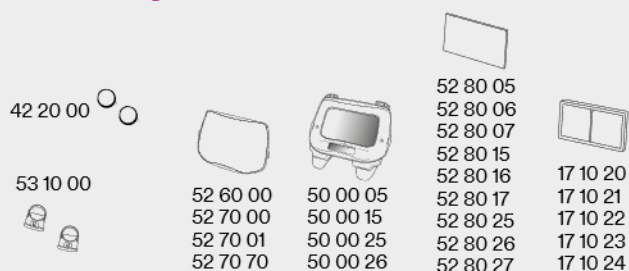

Passive Filter

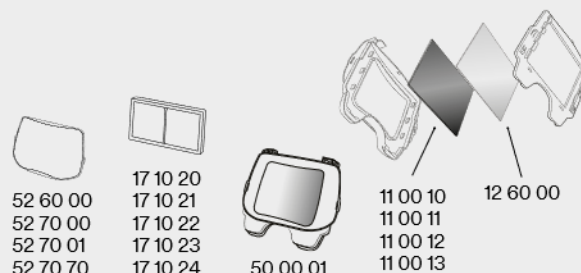

| Part No | Description | Part No | Description | Part No | Description |
|----------|--|----------|---|----------|---|
| 16 80 15 | Comfort sweatband, pkg of 3. | 52 70 01 | Outer protection plate extra scratch resistant, pkg of 10. | 53 10 00 | Battery holder, pkg of 2. |
| 16 90 06 | Head protection, (small). | 52 70 70 | Outer protection plate, heat resistant, pkg of 10. | 53 20 16 | Side windows cover plate, 2 pairs. |
| 16 90 07 | Head protection, (large). | 52 80 05 | Inner cover plate for 9100V filter, pkg of 5. Plate marking 117x50. | 53 30 00 | Headband with assembly parts. |
| 16 90 10 | Neck protection. | 52 80 06 | Inner cover plate, +1 shade for 9100V filters, pkg of 3. | 53 35 00 | Air duct. |
| 16 91 00 | Hood. | 52 80 07 | Inner cover plate, +2 shade for 9100V filters, pkg of 3. | 53 40 00 | Face seal. |
| 17 10 20 | Magnifying lens 1.0. | 52 80 15 | Inner cover plate for 9100X filter, pkg of 5. Plate marking 117x61. | 53 50 00 | Air deflector parts. |
| 17 10 21 | Magnifying lens 1.5. | 52 80 16 | Inner cover plate, +1 shade for 9100X filter, pkg of 3. | 53 60 00 | Pivot mechanism, left and right. |
| 17 10 22 | Magnifying lens 2.0. | 52 80 17 | Inner cover plate, +2 shade for 9100X filter, pkg of 3. | 53 61 00 | Headband, front part. |
| 17 10 23 | Magnifying lens 2.5. | 52 80 25 | Inner cover plate for 9100XX/9100XXi filters, pkg of 5. Plate marking 117x77. | 53 62 00 | Headband, back part. |
| 17 10 24 | Magnifying lens 3.0. | 52 80 26 | Inner cover plate, +1 shade for 9100XX/9100XXi filters, pkg of 3. | 54 05 00 | Front cover kit. |
| 19 71 44 | Hinge mechanism, 2 pcs | 52 80 27 | Inner cover plate, +2 shade for 9100XX/9100XXi filters, pkg of 3. | 54 18 90 | Helmet without welding filter, without face seal, without air duct, without headband. |
| 42 20 00 | Battery CR2032 Lithium 3V, pkg of 2. | | | 54 28 00 | Helmet without welding filter, with headband. |
| 50 00 05 | Speedglas welding filter 9100V. | | | 79 01 01 | Product storage bag. |
| 50 00 15 | Speedglas welding filter 9100X. | | | 89 10 14 | Hook & loop for head cover, pkg of 2. |
| 50 00 25 | Speedglas welding filter 9100XX. | | | 89 10 15 | 9100 FX Air service kit (not shown). |
| 50 00 26 | Speedglas welding filter 9100XXi. | | | | |
| 52 30 00 | Visor plate, standard, pkg of 5. | | | | |
| 52 30 01 | Visor plate, anti-fog, pkg of 5. | | | | |
| 52 60 00 | Outer protection plate, standard, pkg of 10. | | | | |
| 52 70 00 | Outer protection plate scratch resistant, pkg of 10. | | | | |

3M™ Speedglas™ Welding Helmets 9100 MP/9100 MP-Lite



57 77 15



59 88 00



50 00 26



50 00 01



50 00 05



50 00 15



50 00 25

Helmet systems with powered air

| Part No | Description |
|------------------------|---|
| 57 77 00 ¹⁾ | Welding helmet 9100MP without welding filter, with Adflo powered air respirator. |
| 59 77 00 ¹⁾ | Welding helmet 9100MP-Lite without welding filter, with Adflo powered air respirator. |
| 57 77 15 ¹⁾ | Welding helmet 9100MP with welding filter 9100X (54×107 mm) and Adflo powered air respirator. |
| 57 77 25 ¹⁾ | Welding helmet 9100MP welding filter 9100XX (73×107 mm) and Adflo powered air respirator. |
| 57 77 26 ¹⁾ | Welding helmet 9100MP welding filter 9100XXi (73×107 mm) and Adflo powered air respirator. |

Helmet systems with supplied air

| Part No | Description |
|------------------------|---|
| 57 85 00 ¹⁾ | Welding helmet 9100MP without welding filter, with Versaflo supplied air regulator V-500E. |
| 59 88 00 ¹⁾ | Welding helmet 9100MP-Lite without welding filter, with Versaflo supplied air regulator V-500E. |

Please note, supplied air regulators with heating or cooling (V-100/V-200) only as separate order (not as system), see page 15 and 20.

Alternative 3M™ Speedglas™ Welding Filters

| Part No | Description |
|----------|---|
| 50 00 01 | Passive filter kit 9100 (90×110 mm), shade 11. |
| 50 00 05 | Auto-darkening filter 9100V (45×93 mm), variable shade 5, 8, 9–13. |
| 50 00 15 | Auto-darkening filter 9100X (54×107 mm), variable shade 5, 8, 9–13. |
| 50 00 25 | Auto-darkening filter 9100XX (73×107 mm), variable shade 5, 8, 9–13. |
| 50 00 26 | Auto-darkening filter 9100XXi (73×107 mm), variable shade 5, 8, 9–13. |

Maintenance tips for 3M™ Speedglas™ Welding Helmet 9100 MP

Subscribe to our YouTube channel to learn more about product features and maintenance. A few examples:



Scan QR-code or use this URL:

www.youtube.com/3MSpeedglas



Need to re-fresh the head protection on your 9100MP? See how to remove the safety helmet.

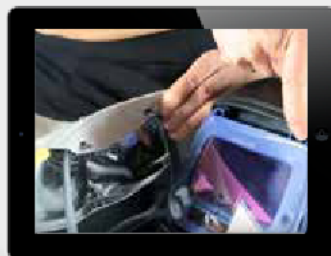

See how to install the heat-reflecting, silver-coated helmet cover, helping to shed dust and particles from your helmet.

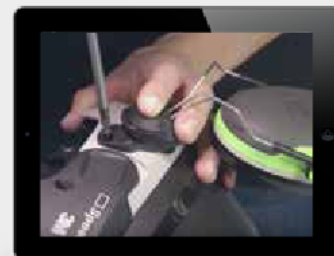

Need higher attenuation for your hearing protection, or is it just time to replace the old ones? See how to assemble the ear muffs in this video.

¹⁾ With storage bag (79 01 01)

Spare parts & accessories for 3M™ Speedglas™ Welding Helmets 9100 MP/9100 MP-Lite

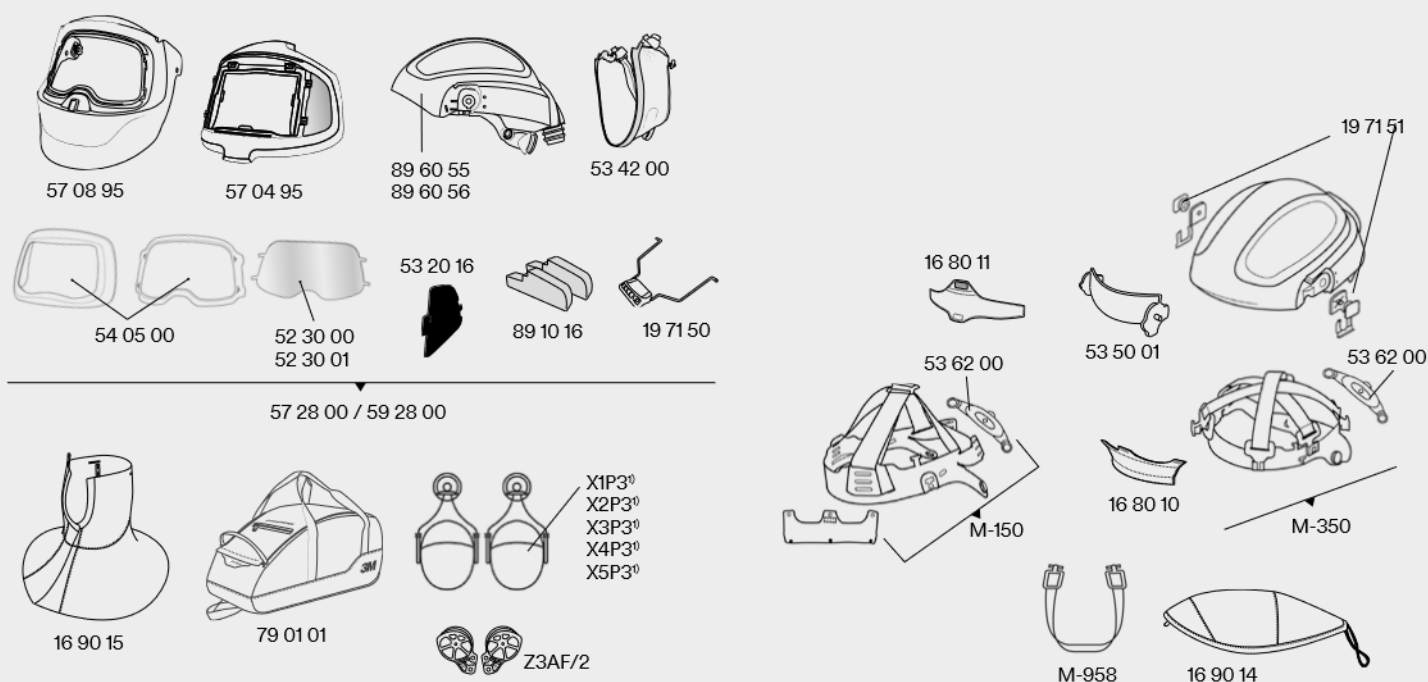

Auto-darkening Filter

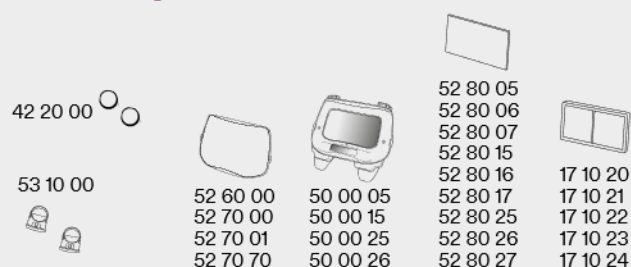

Passive Filter

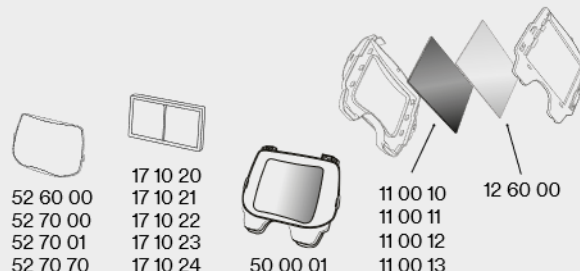

| Part No | Description | Part No | Description | Part No | Description |
|----------|---|----------|---|----------|--|
| 16 80 10 | Sweatband 9100 MP, pkg of 2. | 52 70 01 | Outer protection plate extra scratch resistant, pkg of 10. | 53 50 01 | Helmet air flow deflector for 9100 MP-Lite. |
| 16 80 11 | Sweatband 9100 MP-Lite, for TH3 level of protection pkg of 2 (not included in M-150). | 52 70 70 | Outer protection plate heat resistant, pkg of 10. | 53 62 00 | Headband ratchet. |
| 16 90 01 | Neck protection. | 52 80 05 | Inner cover plate for 9100V filter, pkg of 5. Plate marking 117×50. | 54 05 00 | Front cover kit. |
| 16 90 14 | Safety helmet cover. | 52 80 06 | Inner cover plate, +1 shade for 9100V filters, pkg of 3. | 57 04 95 | Outer shield. |
| 16 90 15 | Shroud. | 52 80 07 | Inner cover plate, +2 shade for 9100V filters, pkg of 3. | 57 08 95 | Inner shield. |
| 17 10 20 | Magnifying lens 1.0. | 52 80 15 | Inner cover plate for 9100X filter, pkg of 5. Plate marking 117×61. | 57 28 00 | Welding helmet 9100MP, without welding filter. |
| 17 10 21 | Magnifying lens 1.5. | 52 80 16 | Inner cover plate, +1 shade for 9100X filter, pkg of 3. | 59 28 00 | Welding helmet 9100 MP-Lite, without welding filter. |
| 17 10 22 | Magnifying lens 2.0. | 52 80 17 | Inner cover plate, +2 shade for 9100X filter, pkg of 3. | 89 60 55 | Safety helmet 9100 MP, incl head suspension and sweatband. |
| 17 10 23 | Magnifying lens 2.5. | 52 80 25 | Inner cover plate for 9100XX/9100XXi filters, pkg of 5. Plate marking 117×77. | 89 60 56 | Safety helmet 9100 MP-Lite, incl head suspension and sweatband. |
| 17 10 24 | Magnifying lens 3.0. | 52 80 26 | Inner cover plate, +1 shade for 9100XX/9100XXi filters, pkg of 3. | 79 01 01 | Product storage bag. |
| 19 71 50 | Flip-up mechanism. | 52 80 27 | Inner cover plate, +2 shade for 9100XX/9100XXi filters, pkg of 3. | M-150 | Head suspension for 9100 MP-Lite. |
| 19 71 51 | Pivot kit. | 53 10 00 | Battery holder, pkg of 2. | M-350 | Head suspension for 9100 MP. |
| 42 20 00 | Battery CR2032 Lithium 3V, pkg of 2. | 53 20 16 | SideWindow cover plates. | M-958 | Chin strap. |
| 50 00 05 | Speedglas welding filter 9100V. | 53 42 00 | Face seal. | X1P3 | 3M™ Peltor™ Ear Muffs X1 (26 dB). ¹⁾ |
| 50 00 15 | Speedglas welding filter 9100X. | | | X2P3 | 3M™ Peltor™ Ear Muffs X2 (30 dB). ¹⁾ |
| 50 00 25 | Speedglas welding filter 9100XX. | | | X3P3 | 3M™ Peltor™ Ear Muffs X3 (32 dB). ¹⁾ |
| 50 00 26 | Speedglas welding filter 9100XXi. | | | X4P3 | 3M™ Peltor™ Ear Muffs X4 (32 dB). ¹⁾ |
| 52 30 00 | Visor plate, standard, pkg of 5. | | | X5P3 | 3M™ Peltor™ Ear Muffs X5 (36 dB). ¹⁾ |
| 52 30 01 | Visor plate, anti-fog, pkg of 5. | | | Z3AF/2 | Helmet assembly parts for Peltor X-series ear muffs, left and right. |
| 52 60 00 | Outer protection plate, standard, pkg of 10. | | | | |
| 52 70 00 | Outer protection plate scratch resistant, pkg of 10. | | | | |

1) Please add assembly parts Z3AF/2 when ordering ear muffs for 9100 MP and 9100 MP-Lite welding helmets.

3M™ Speedglas™ Welding Helmet Series 9000 for respiratory protection



Spare parts & accessories



| Part No | Description | Part No | Description | Part No | Description |
|----------|---|----------|---|----------|--|
| 16 40 05 | Ear and neck protection in leather. | 42 60 00 | Outer protection plate, standard, pkg of 10. Plate marking 42 01 50. | 43 20 02 | Front cover. |
| 16 40 09 | Head protection. | 42 70 00 | Outer protection plate, scratch resistant, pkg of 10. Plate marking 42 01 00. | 43 20 15 | Side windows cover plate (sticker), 5 pairs. |
| 16 60 20 | Assembly parts for headband. | 42 70 71 | Outer protection plate, heat resistant, pkg of 10. Plate marking 42 01 71. | 43 30 00 | Headband with air duct. |
| 16 75 20 | Sweatband, towelling, pkg of 2. | 42 80 00 | Inner cover plate (42×91 mm), pkg of 5. Plate marking 42 02 00. | 43 30 10 | Air duct. |
| 16 76 00 | Sweatband, towelling, pkg of 20. | 42 80 10 | Inner cover plate (53×103 mm), pkg of 5. Plate marking 42 02 10. | 43 30 60 | Headband without air duct. |
| 16 80 00 | Sweatband, leather. | 42 80 20 | Inner cover plate (42×91 mm), +1 Shade, pkg of 5. | 43 40 01 | Face seal. |
| 16 80 12 | Sweatband, fleecy cotton, pkg of 2. | 42 80 30 | Inner cover plate (53×103 mm), +1 Shade, pkg of 5. | 43 50 00 | Air spreader. |
| 16 90 01 | Neck protection. | 42 80 40 | Inner cover plate (42×91 mm), +2 Shade, pkg of 5. | 44 05 00 | FlexView kit. |
| 16 91 00 | Hood. | 42 80 50 | Inner cover plate (53×103 mm), +2 Shade, pkg of 5. | 44 10 00 | Middle helmet FlexView, black. |
| 17 10 20 | Magnifying lens 1.0. | 43 10 00 | Battery cover, pkg of 2. | 44 20 00 | Heat-reflecting front cover FlexView, silver. |
| 17 10 21 | Magnifying lens 1.5. | | | 80 31 10 | Tightening kit for Speedglas 9000 welding helmet, not shown. |
| 17 10 22 | Magnifying lens 2.0. | | | | |
| 17 10 23 | Magnifying lens 2.5. | | | | |
| 17 10 24 | Magnifying lens 3.0. | | | | |
| 19 71 40 | Holder for welding filter (FlexView). | | | | |
| 42 20 00 | Battery CR 2032 Lithium 3V, pkg of 2. | | | | |
| 42 30 00 | Protective visor plate FlexView, pkg of 10. | | | | |

3M™ Safety Helmet H-701

The 3M™ Speedglas™ Quick Release (QR) Rail allows you to attach a Speedglas welding helmet to many of the industry's most popular safety helmets. 3M offers complete QR welding helmet system,

including the white, unvented 3M™ Safety Helmet H-701. The safety helmet is available in 6 colours when you buy it separately, see below.

Internal slots for accessory earmuffs.

Ventilated headband and ratchet suspension for improved comfort.



For Quick Release (QR) welding helmets we offer the unvented safety helmet model (H-701N-VI) for optimal protection of sparks and radiation.

Applicable to
EN397:2012 + A1:2012.
Very low temperature (-30 C)
Molten metal splash (MM)
Electrical insulation (440 Vac)

Short brim and compact design for increased user mobility and visibility.



H-701N-GU



H-701N-VI



H-701N-OR



H-701N-GP



H-701N-BB



H-701N-RD





M-972



M-958

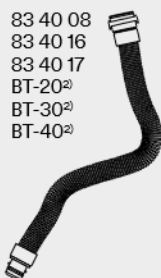

83 40 08
83 40 16
83 40 17
BT-20²⁾
BT-30²⁾
BT-40²⁾



83 40 18

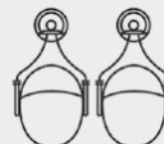

X1P3²⁾
X2P3²⁾
X3P3²⁾
X4P3²⁾
X5P3²⁾



73AE/2

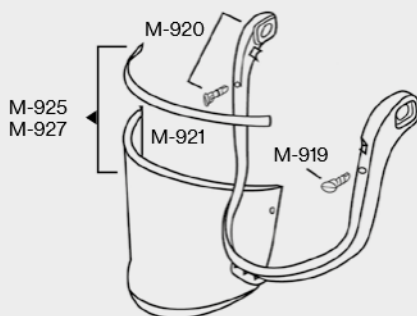

M-925
M-927

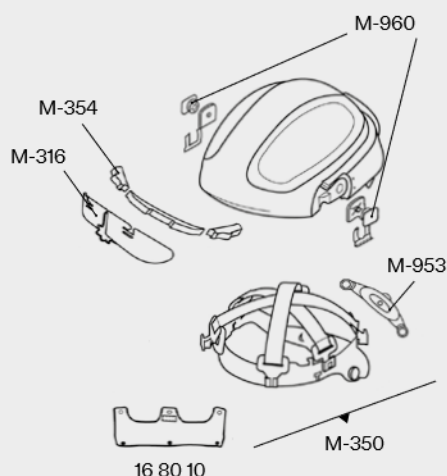

M-960

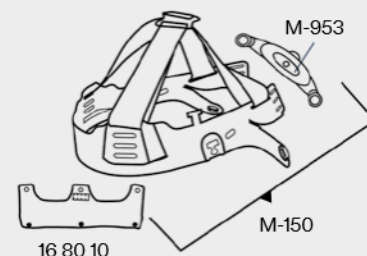

M-953

M-150



M-928



M-937



M-116



M-976

For powered air respirator options, please see page 18. For supplied air regulator options, see page 20.

2) Please add assembly parts Z3AF/2 when ordering ear muffs for Versaflo Headtops M-Series.

3M™ Protective Visor for respiratory protection



Spare parts

| Part No | Description |
|----------|--|
| 16 40 09 | Head cover flame-resistant. |
| 16 80 12 | Sweatband. |
| 80 30 10 | Headband, with air duct. |
| 80 30 60 | Headband, without air duct. |
| 80 40 05 | Face seal. |
| 85 30 56 | Breathing tube, with nipple, silencer and fastening details. |
| 89 10 13 | Hook and loop for face seal, pkg of 2. |
| 89 90 40 | Protective Visor, clear, polycarbonate, with face seal, without brow protection. |
| 89 90 41 | Protective Visor, clear, acetate, with face seal, without brow protection. |
| 89 90 45 | Protective Visor, DIN 5, polycarbonate, with face seal, without brow protection. |
| 89 90 51 | Brow protection (powered air). |
| 89 90 60 | Protection film, pkg of 5. |
| 89 91 40 | Protective Visor, clear, polycarbonate, with face seal, without brow protection. |
| 89 91 41 | Protective Visor, clear, acetate, with face seal, without brow protection. |
| 89 91 45 | Protective Visor DIN 5, polycarbonate, with face seal, without brow protection. |
| 89 91 51 | Brow protection (supplied air). |

